

Shenzhen Kaidechang Electronic Technology Co., Ltd

Email: 3176708292@qq.com

13265873957@163.com

Number: +86-13265873957

+86-18123659512

<http://www.huoerxin.com>

Pressure pickup

Main applications



Automation equipment



Precision medicine



New energy lithium batteries



Robot



Semiconductor



Air Railway



Colleges and universities



KDEV-L-09

Customizable:  high temperature

Product characteristics

- The sensor adopts stainless steel shell, round shape, structure is strong and durable. It has good natural linearity, strong anti-eccentric load ability, high precision, low profile height, easy and stable installation.
- Widely used hopper scale, truck scale, track scale and other electronic scales.

Mounting dimensions

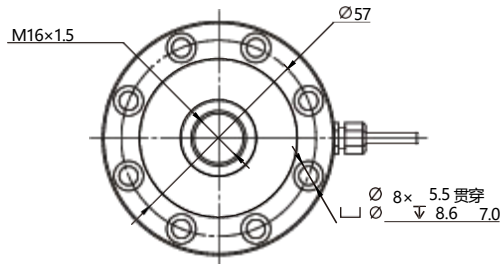
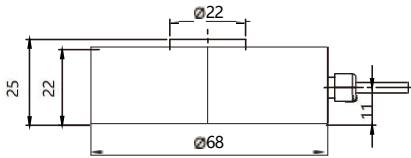

Force mode

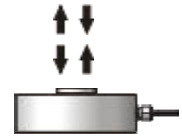

Technical parameters			
Measuring range	10/20/50/100/200/500 kg,1/2/3/5 T	Sensitivity temperature effect	±0.05%F.S/10°C
Composite Error	±0.1%F.S.	Zero temperature effect	±0.05%F.S/10°C
Non-linear	0.1%F.S.	Temperature compensation range	- 10~40°C
Output sensitivity	1.0/2.0±10%mV/V	Operating temperature range	-20~60°C
Lag behind)	0.1%F.S	Recommended excitation voltage	5~ 10V
Service life	Over 1 million times	Maximum excitation voltage	12V
Materials	stainless steel	SAFE overload range	120%F.S
Cable specifications	Φ5mm×3m	Limit Overload Range	150%F.S
Insulation Resistance	≥5000MΩ/100V DC	Protection level	Ip66

KDEV-L-A0

Customizable:  high temperature



Product characteristics

- It is made of sensor special alloy steel, sealed with adhesive, anodized on the surface, suitable for various working conditions, simple structure, convenient installation and double-direction stress. It is suitable for testing machine, hydraulic press, cold and hot press, electronic hook scale, Hopper scale, etc. .

Mounting dimensions

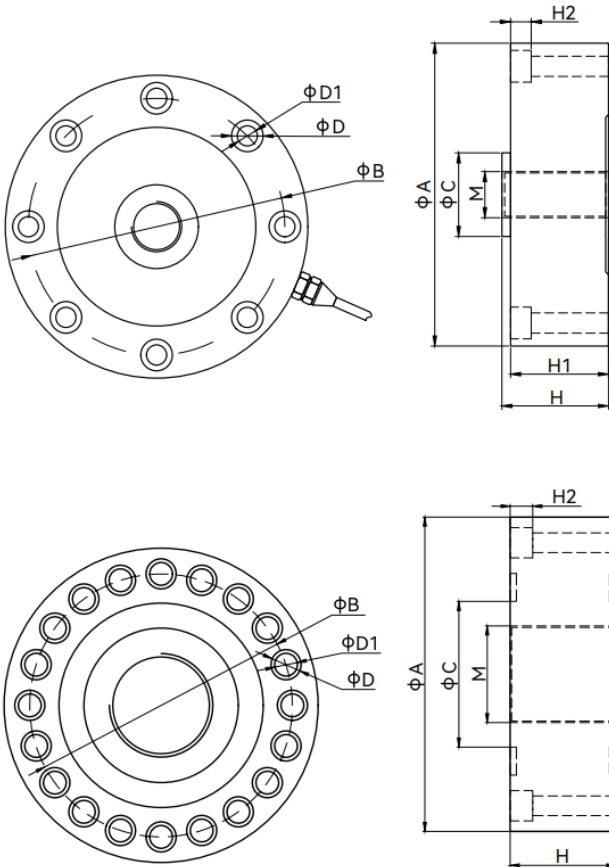

	ΦA	ΦB	ΦC	M	H	H1	H2	ΦD	ΦD1
20-1000kg	74	63	24	M16*1.5	34	30	7.2	8-Φ9	8-Φ6
1-5T	105	89	29	M16*1.5	37	34	7.2	8-Φ11	8-Φ7
10-20T	120.6	101.8	39	M32*1.5	53.5	41	10.5	8-Φ14	8-Φ9
30T	141	116.8	50.4	M40*1.5	57.2	50.8	11	8-Φ18	8-Φ11

量程	ΦA	ΦB	ΦC	M	H	H2	ΦD	ΦD1
40-80T	208	174	95	M64*3	70	15	16-Φ20	16-Φ13
100-200T	280	230	136	M76*3	90	20	16-Φ26	16-Φ17
300-400T	360	300	190	M100*3	110	20	20-Φ40	20-Φ25
500-600T	420	370	266	M130*4	140	30	20-Φ42	20-Φ28
800-1000T	500	440	330	M200*4	170	30	12-Φ42	12-Φ28

Force mode



Technical parameters

Measuring range	20/50/100/200/500/1000	kg, 1/2/3/5/10/20/30/50/100/200/300/400/500/600/800/1000	T
Composite Error	20kg-5T	≤±0.05%	Cable specifications Φ5mm×3m
	10-80T	≤±0.1%	
	100-400T	≤±0.2%	
	500-1000T	≤±0.5%	
Non-linear	≤0.05-0.5%	Sensitivity temperature effect	±0.03%F.S/10°C
Sensitivity	2.0±10%mV/V	Zero temperature effect	±0.03%F.S/10°C
Creep	±0.03%F.S/30min	Temperature compensation range	-20~60°C
Zero output	±1.0%F.S	Operating temperature range	-20~80°C
Excitation voltage	5~15V	SAFE overload range	150%F.S
Insulation Resistance	≥5000MΩ/100V DC	Limit Overload Range	200%F.S
Impedance	20- 1000kg: 700/1400Ω	1-30T: 700Ω	50- 1000T:1400Ω
Protection level	Ip66		

KDEV-L-A1

Customizable:  high temperature



Mounting dimensions

Measuring range	D	M	ΦC	ΦB
2-3T	Φ98	M36*2	82	44
4-10T	Φ118	M42*2	98	56

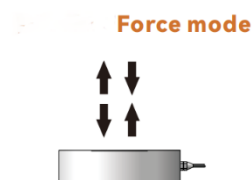
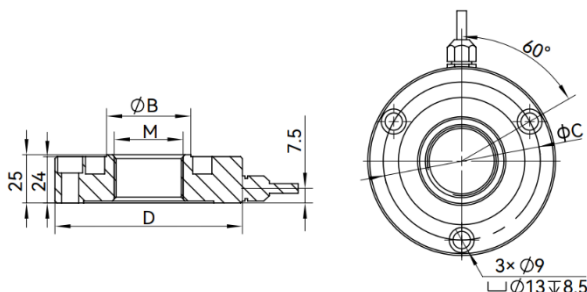

Technical parameters			
Measuring range	2/3/4/5/10 T	Sensitivity temperature effect	±0.1%F.S/10°C
Composite Error)	≤±0.3%	Zero temperature effect	±0.1%F.S/10°C
Non-linear)	0.3%	Temperature compensation range	-10~40°C
Sensitivity)	2.0±0.1mV/V	Operating temperature range	-20~65°C
Creep)	±0.05%F.S/30min	Excitation voltage	5~12V
Zero output)	±1.0%F.S	SAFE overload range	150%F.S
Input impedance)	760±5Ω	Limit Overload Range	200%F.S
Output impedance)	700±5Ω	Cable specifications	Φ6mm×2m
Insulation Resistance)	≥5000MΩ/100V DC	Protection level	Ip66



KDEV-L-C0

Customizable:  high temperature  waterproof

Product characteristics

- Small shape, large stress area, stainless steel material, suitable for a variety of small space force measurement, widely used in industrial R & D and other fields of measurement and control.

Mounting dimensions

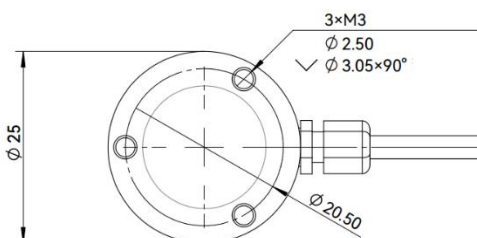
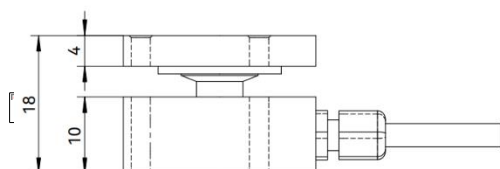

Technical parameters			
Measuring range	5/10/20/50/100/200/500/1000/2000 kg	Sensitivity temperature effect	±0.1%F.S/10°C
Composite Error	≤±0.3%	Zero temperature effect	±0.1%F.S/10°C
Non-linear	0.3%	Temperature compensation range	-10~60°C
Sensitivity	1.5±20%mV/V	Operating temperature range	-20~80°C
Creep	±0.1%F.S/30min	Excitation voltage	5~15V
Zero output	±1.0%F.S	SAFE overload range	150%F.S
Input impedance	350±50Ω	Limit Overload Range	200%F.S
Output impedance	350±5Ω	Cable specifications	Φ3mm×3m
Insulation Resistance	≥5000MΩ/100V DC	Protection level	Ip67



KDEV-L-C1

Customizable:  high temperature  waterproof

Product characteristics

- Small shape, large stress area, upper and lower lange fixed, stainless steel material, suitable for plane force measurement applications, widely used in industrial R & D and other fields of measurement and control.

Mounting dimensions

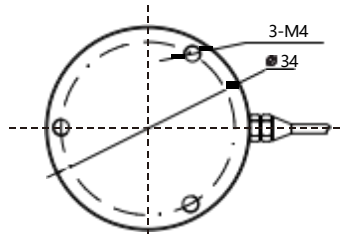
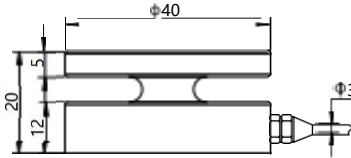

Force mode

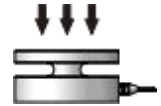

Technical parameters			
Measuring range	10/20/50/100/200/500/1000 kg	Sensitivity temperature effect	±0.05%F.S/10°C
Composite Error	≤±0.2%	Zero temperature effect	±0.05%F.S/10°C
Non-linear	0.2%	Temperature compensation range	-10~60°C
Sensitivity	1.5±20%mV/V	Operating temperature range	-20~80°C
Creep	±0.1%F.S/30min	Excitation voltage	5~15V
Zero output	±1.0%F.S	SAFE overload range	150%F.S
Input impedance	800~1000Ω	Limit Overload Range	200%F.S
Output impedance	800~1000Ω	Cable specifications	Φ3mm×3m
Insulation Resistance	≥5000MΩ/100V DC	Protection level	Ip67



KDEV-L-C2

Customizable:  high temperature  waterproof

Product characteristics

- Large stress area, upper and lower lange fixed, stainless steel material, suitable for a variety of small space force measurement, weighing is widely used in industrial r & D and other fields of measurement and control.

Mounting dimensions

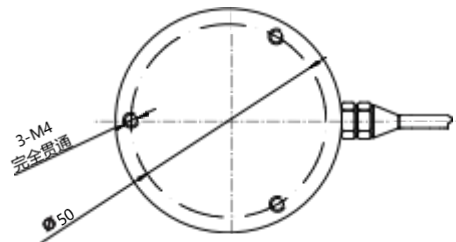
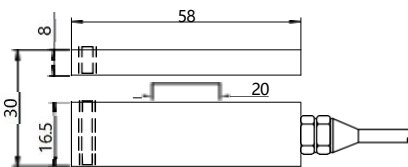

Force mode

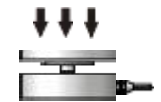

Technical parameters			
Measuring range	20/30/50/100/200/300/500 kg, 1/2/3/5/10 T	Sensitivity temperature effect	±0.1%F.S/10°C
Composite Error	≤±0.3%	Zero temperature effect	±0.1%F.S/10°C
(Non-linear)	0.3%	Temperature compensation range	-10~60°C
Sensitivity	1.5±20%mV/V	Operating temperature range	-20~80°C
Creep	±0.1%F.S/30min	Excitation voltage	5~15V
Zero output	±1.0%F.S	SAFE overload range	150%F.S
Input impedance	350±50Ω	Limit Overload Range	200%F.S
Output impedance	350±5Ω	Cable specifications	Φ5mm×3m
Insulation Resistance)	≥5000MΩ/100V DC	防护等级 (Protection level)	Ip67

KDEV-L-C3

Customizable:  high temperature  waterproof



产品特点 / Product characteristics

- Low height, large stress area, stainless steel material, suitable for a variety of small space force measurement, widely used in industrial R & D and other fields of large range measurement and control.

Mounting dimensions

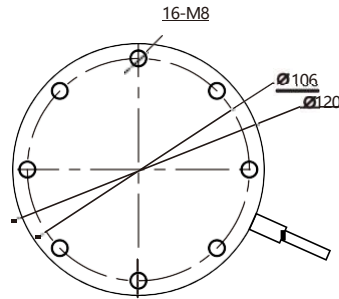
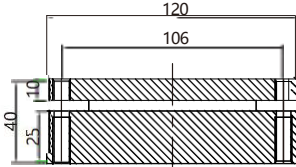

Force mode

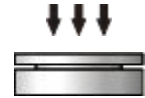

Technical parameters

Measuring range	0.5T/1T/2T/3T/5T/10T	Insulation resistance	$\geq 5000M\Omega/100V(DC)$
Output sensitivity	$2.0 \pm 10\%$	Temperature sensitivity drift	$0.1\%F.S./10^{\circ}C$
Zero output	$0.05F.S.$	Output impedance	$0.1\%F.S./10^{\circ}C$
Supply Voltage	$5 \sim 12VDC$	Sensitivity to temperature effects	$0.1\%F.S./10^{\circ}C$
Comprehensive accuracy	0.2%	Zero temperature drift	$0.1\%F.S./10^{\circ}C$
Non-linearity	$0.2\%F.S.$	Temperature compensation range	$-10 \sim 60^{\circ}C$
Repeatability	$0.2\%F.S.$	Operating temperature range	$-20 \sim 80^{\circ}C$
Input Resistance	$700 \pm 10\Omega$	SAFE overload	$150\%F.S.$
Output Resistance	$700 \pm 5\Omega$	Ultimate overload	$200\%F.S.$
Cable specifications	$\phi 5mm \times 3m$		



KDEV-L-D01

Product characteristics

- Adopt high precision resistance strain type principle, stainless steel material, sealing welding oil-proof, waterproof, corrosion-resistant. Circular structure design, pressure bearing, easy to install and use, mainly used in automotive, medical, robotics, electronics, mechanical equipment, automation equipment.

Mounting dimensions

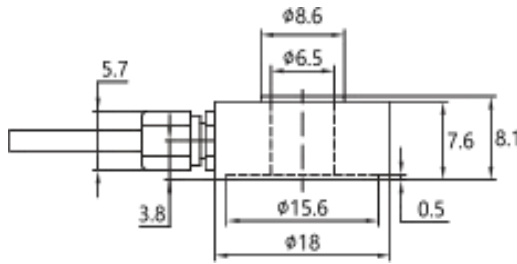
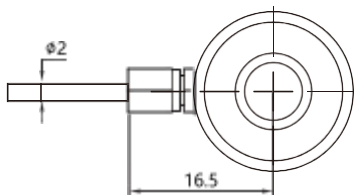

Force mode

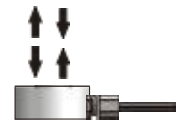

Technical parameters

Measuring range	0-5/10/20/30/ 50 kg	Temperature sensitivity drift	$\pm 0.1\% F.S. / 10^{\circ}C$
Output sensitivity	$1.5 \pm 10\% mV/V$	Zero temperature drift	$\pm 0.1\% F.S. / 10^{\circ}C$
Zero output	$\pm 2\% F.S.$	Use voltage	$3 \sim 5V$
Nonlinear	$\pm 0.5\% F.S.$	Operating temperature range	$-20 \sim 80^{\circ}C$
Lag	$\pm 0.5\% F.S.$	Compensation temperature range	$-10 \sim 60^{\circ}C$
Repeatability	$\pm 0.5\% F.S.$	Safety overload	120%
Creep (30 min)	$\pm 0.05\% F.S.$	Extreme overload	150%
Input impedance	$350(700) \pm 10\Omega$	Cable specifications	$\phi 2mm \times 3m$
Output impedance	$350(700) \pm 5\Omega$	Material	Stainless Steel
Insulation Resistance	$\geq 5000M\Omega/100VDC$	Protection level	IP65

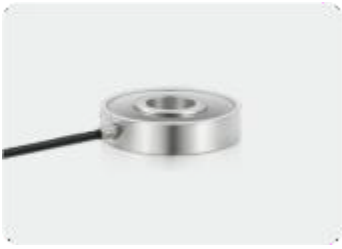

Mounting dimensions

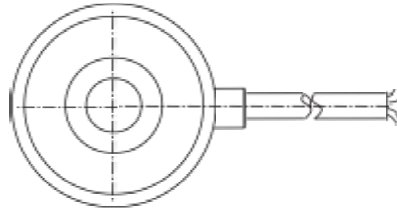
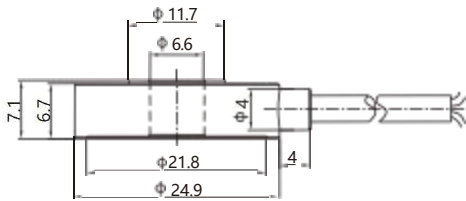

Force mode

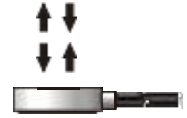

KDEV-L-D0

Customizable:  high temperature

Product characteristics

- Low height, small deformation, small size, ring design, stainless steel material, high dynamic response frequency. Suitable for pressing parts, automatic assembly, 3C product test, New Energy Product Assembly, medical inspection, robotics field.

Technical parameters

Measuring range	5/10/20/50/100 kg	Sensitivity temperature effect	±0.05%F.S/10°C
Composite Error	≤±0.5%	Zero temperature effect	±0.05%F.S/10°C
Non-linear	0.5%	Temperature compensation range	-10~60°C
Sensitivity	1.5±20%mV/V	Operating temperature range	-20~80°C
Creep	±0.5%F.S/30min	Excitation voltage	5~12V
Zero output	±2.0%F.S	SAFE overload range	150%F.S
Input impedance	700±20Ω	Limit Overload Range	200%F.S
Output impedance	700±10Ω	Cable specifications	Φ2mm×3m
Insulation Resistance	≥5000MΩ/100V DC	Protection level	Ip66

KDEV-L-D1

Customizable:  high temperature



Mounting dimensions

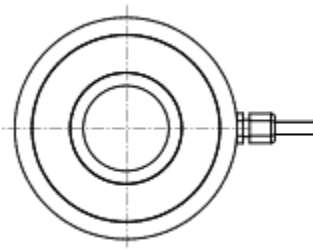
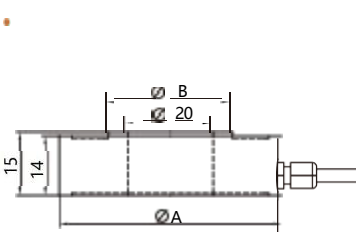

Force mode



Product characteristics

- Special stainless steel material, high dynamic response frequency. Suitable for automobile press assembly, automatic assembly, 3C product testing, new energy product assembly, medical testing, robotics, mold assembly and other industrial testing, measurement and control systems.

	A	B
10/20/50/100/200/500 kg 1/2/3/5T	52	29
10/15/20T	62	34

Technical parameters

Measuring range	10/20/50/100/200/500 kg, 1/2/3/5/10/15/20 T	Sensitivity temperature effect	±0.05%F.S/10°C
Composite Error	≤±0.5%	Zero temperature effect	±0.05%F.S/10°C
Non-linear	0.5%	Temperature compensation range	-10~60°C
Sensitivity	1.5±20%mV/V	Operating temperature range	-20~80°C
Creep	±0.1%F.S/30min	Excitation voltage	5~12V
Zero output	±2.0%F.S	SAFE overload range	150%F.S
Input impedance	780±20Ω	Limit Overload Range	200%F.S
Output impedance	700±10Ω	Cable specifications	Φ3mm×3m
Insulation Resistance	≥5000MΩ/100V DC	Protection level	Ip66

KDEV-L-D2

Customizable: 
high temperature



Product characteristics

- Small size, large range, sensor special stainless steel. Suitable for all kinds of small space force measurement, thread force monitoring, widely used in industry, research and development and other fields of measurement control.

Mounting dimensions

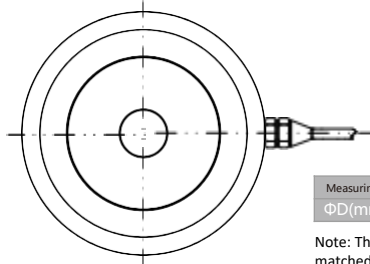
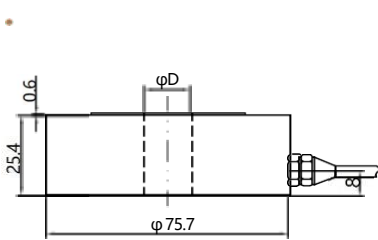

Measuring range	1/2/3/5/10/20 T
ΦD(mm)	7/9/11/15/17/19/21/25/32

Note: The inner diameter and range can be freely matched and customized

Force mode

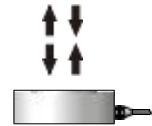

Technical parameters

Measuring range	1/2/3/5/10/20 T	Sensitivity temperature effect	±0.05%F.S/10°C
Composite Error	≤±0.5%	Zero temperature effect	±0.05%F.S/10°C
Non-linear	0.5%	Temperature compensation range	-10~60°C
Sensitivity	1.5±0.05% <i>mV/V</i>	Operating temperature range	-20~80°C
Creep	±0.5%F.S/30min	Excitation voltage	5~12V
Zero output	±2.0%F.S	SAFE overload range	150%F.S
Input impedance	780±20Ω	Limit Overload Range	200%F.S
Output impedance	700±10Ω	Cable specifications	Φ5mm×3m
Insulation Resistance	≥5000MΩ/100V DC	Protection level	Ip66



KDEV-L-D4

Customizable: 
high temperature

Product characteristics

The sensor has the advantages of low profile, anti-eccentric load, high precision, good strength, easy installation and good symmetry of tension and compression output. Application: widely used in industrial system of force measurement and crane scale, rail scale, hopper scale and other weighing, force measurement of industrial automation measurement and control system.

Mounting dimensions

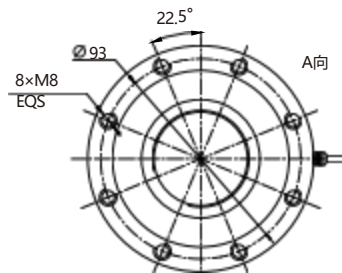
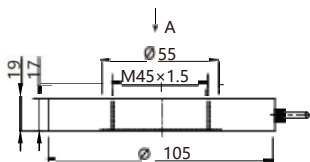

Force mode



Technical parameters

Measuring range	50/100/200/500 kg, 1/2/5 T	Sensitivity temperature effect	±0.1%F.S/10°C
Composite Error	±0.3%F.S.	Zero temperature effect	±0.1%F.S/10°C
Non-linear	0.2%F.S.	Temperature compensation range	-10~40°C
Output sensitivity	1.0/2.0±10% <i>mV/V</i>	Operating temperature range	-20~60°C
Lag behind	0.15%F.S	Recommended excitation voltage	5~10V
Service life	100万次以上	Maximum excitation voltage	12V
Materials	合金钢	SAFE overload range	120%F.S
Cable specifications	Φ5mm×3m	Limit Overload Range	150%F.S
Insulation Resistance	≥5000MΩ/100V DC	Protection level	Ip66



KDEV-L-D5

Customizable:  high temperature

Product characteristics

- This product adopts high-quality alloy steel, advanced elastomer processing technology, small size, low mounting table, stable and reliable performance. It is suitable for measuring force value under special temperature environment or cooperating with computer control system to test and collect data.

Mounting dimensions

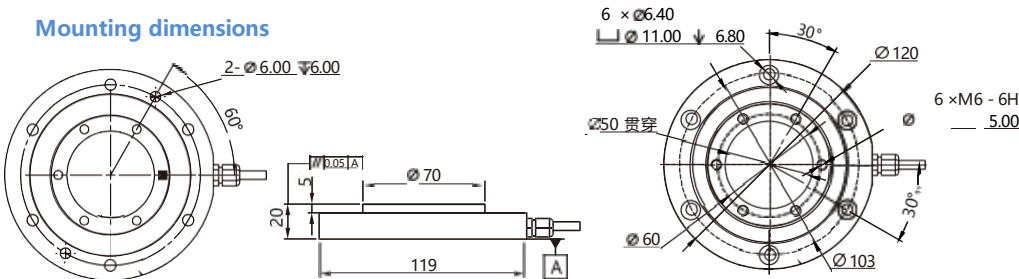

Force mode

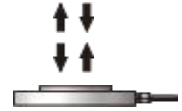

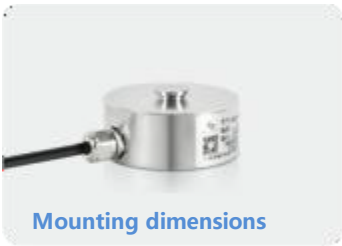

Technical parameters

Measuring range	50/100/200/500 kg, 1/2/3/5 T	Sensitivity temperature effect	±0.15%F.S/10°C
Composite Error	±0.3%F.S.	Zero temperature effect	±0.15%F.S/10°C
Non-linear	0.3%F.S.	Temperature compensation range	-10~40°C
Output sensitivity	1.0/2.0±10% mV/V	Operating temperature range	-20~60°C
Lag behind	0.1%F.S	Recommended excitation voltage	5~10V
Service life	Over 2 million times	Maximum excitation voltage	12V
Materials	alloy steel	SAFE overload range	120%F.S
Cable specifications	Φ5mm×3m	Limit Overload Range	150%F.S
Insulation Resistance	≥5000MΩ/100V DC	Protection level	Ip66



KDEV-L-E11

Customizable:  high temperature  waterproof

Product characteristics

- Adopt sensor special stainless steel material, repeatability, high reliability, long-term stability, small figure large range. Widely used in pressure testing machine, workpiece pressing, material testing machine and other industrial automation equipment.

Mounting dimensions

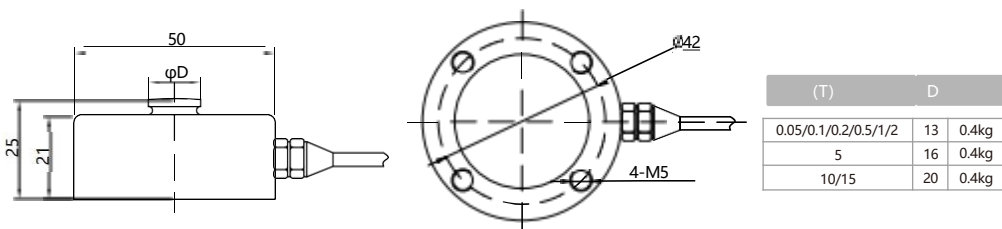

Force mode



Technical parameters

Measuring range	0.05/0.1/0.2/0.5/1/2/5/10/15 T	Sensitivity temperature effect	±0.05%F.S/10°C
Composite Error	≤±0.2%	Zero temperature effect	±0.05%F.S/10°C
Non-linear	0.2%	Temperature compensation range	-10~60°C
Sensitivity	2.0±10% mV/V	Operating temperature range	-20~80°C
Creep	±0.1%F.S/30min	Excitation voltage	5~12V
Zero output	±2.0%F.S	SAFE overload range	120%F.S
Input impedance	750±10Ω	Limit Overload Range	150%F.S
Output impedance	700±5Ω	Cable specifications	Φ5mm×3m
Insulation Resistance	≥5000MΩ/100V DC	Protection level	Ip66



KDEV-L-E12

Customizable:  high temperature  waterproof

Product characteristics

- Stainless steel material, high precision, long-term stability, good repeatability, high reliability, widely used in pressure testing machine, Hopper said, material testing machine, Belt said and other automation equipment.

Mounting dimensions

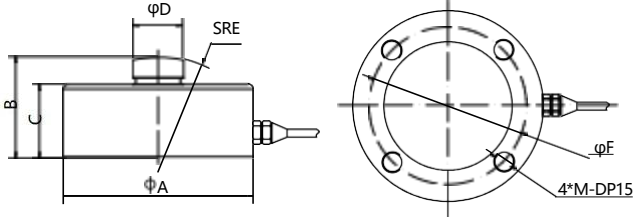

(T)	A	B	C	D	E	F	M
0.5/1/2/3/5/10	82	44	32	22	50	68	M8
15/20	100	48	36	28	100	80	M8
30	126	54	40	35	100	101	M10
50/100	165	80	62	60	150	144	M10

Force mode

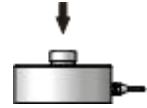

Technical parameters

Measuring range	0.5/1/2/3/5/10/15/20/30/50/100 T	Sensitivity temperature effect	±0.03%F.S/10°C
Composite Error	≤±0.2%	Zero temperature effect	±0.03%F.S/10°C
Non-linear	0.2%	Temperature compensation range	-10~60°C
Sensitivity	2.0±0.01mV/V	Operating temperature range	-20~80°C
Creep	±0.1%F.S/30min	Excitation voltage	5~15V
Zero output	±2.0%F.S	SAFE overload range	120%F.S
Input impedance	750±10Ω	Limit Overload Range	150%F.S
Output impedance	700±5Ω	Cable specifications	Φ5mm×3m
Insulation Resistance	≥5000MΩ/100V DC	Protection level	Ip66



KDEV-L-E3

Customizable:  high temperature  waterproof

Product characteristics

- Compact structure, high comprehensive precision, good long-term stability, high dynamic response frequency, high-quality stainless steel material. Application: Auto Pressing, automatic assembly, 3C product test, New Energy Product Assembly, medical inspection, Robot Field, die assembly and other industrial testing, automation equipment and testing fields.

M

Force mode

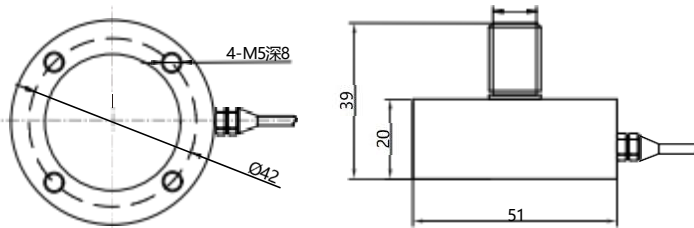

	M
0.05-2T	M12
2.5-5T	M16

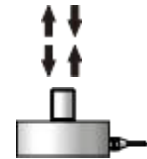

Technical parameters

Measuring range)	0.05/0.1/0.2/0.3/0.5/1/2/3/5 T	Sensitivity temperature effect	±0.05%F.S/10°C
Composite Error)	≤±0.3%	Zero temperature effect	±0.05%F.S/10°C
Non-linear)	0.3%	Temperature compensation range	-10~60°C
Sensitivity)	2.0±10mV/V	Operating temperature range	-20~80°C
Creep)	±1%F.S/30min	Excitation voltage	5~12V
Zero output)	±2.0%F.S	SAFE overload range	150%F.S
Input impedance)	750±20Ω	Limit Overload Range	200%F.S
Output impedance)	700±10Ω	Cable specifications	Φ4mm×3m
Insulation Resistance)	≥5000MΩ/100V DC	Protection level	Ip66



KDEV-L-F0

Customizable:  high temperature

Product characteristics

- A miniature sensor made of special materials for sensors. It is widely used in industrial, R & D and other fields of measurement and control.

Mounting dimensions

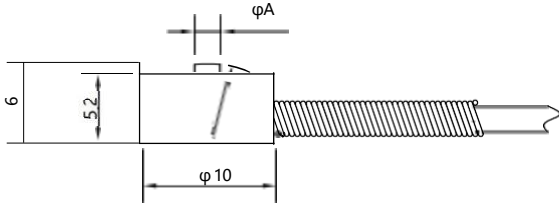

	A
5-30kg	1.5
5-100kg	2.5

Force mode



Technical parameters

Measuring range	5/10/20/30/50/100 kg	Sensitivity temperature effect	±0.1%F.S/10°C
Composite Error	≤±0.3%	Zero temperature effect	±0.1%F.S/10°C
Non-linear	0.3%	Temperature compensation range	-10~60°C/-20~120°C
Sensitivity	1.0/2.0±10% mV/V	Operating temperature range	-20~80°C/-40~160°C
Creep	±0.5%F.S/30min	Excitation voltage	5~12V
Zero output	±2.0%F.S	SAFE overload range	150%F.S
Input impedance	350±10/800~1100Ω	Limit Overload Range	200%F.S
Output impedance	350±5/800~1100Ω	Cable specifications	Φ2mm×1.5m
Insulation Resistance	≥2000MΩ/100V DC	Protection level	Ip66



KDEV-L-F01

Customizable:  high temperature  waterproof

Product characteristics

- The micro-sensor made of special materials for sensors has the characteristics of small volume and large range. It is widely used in the measurement and control of Industrial R & D and other fields.

Mounting dimensions

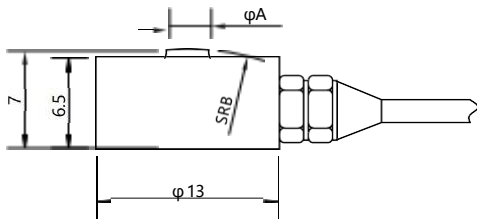

(kg)	A	B
2/5/10/20	2	10
30/50/100/200	3	18

Force mode



Technical parameters

Measuring range	2/5/10/20/30/50/100/200 kg	Sensitivity temperature effect	±0.1%F.S/10°C
Composite Error	≤±0.3%	Zero temperature effect	±0.1%F.S/10°C
Non-linear	0.3%	Temperature compensation range	-10~60°C
Sensitivity	1.0/2.0±10% mV/V	Operating temperature range	-20~80°C
Creep	±0.5%F.S/30min	Excitation voltage	5~12V
Zero output	±2.0%F.S	SAFE overload range	150%F.S
Input impedance	350±10/800~1100Ω	Limit Overload Range	200%F.S
Output impedance	350±5/800~1100Ω	Cable specifications	Φ2mm×2m
Insulation Resistance	≥2000MΩ/100V DC	Protection level	Ip66



KDEV-L-F02

Customizable:  high temperature

Product characteristics

- A miniature sensor made of special materials for sensors. Low height, small diameter, suitable for all small space force measurement, widely used in industrial, R & D and other fields of measurement and control.

Mounting dimensions

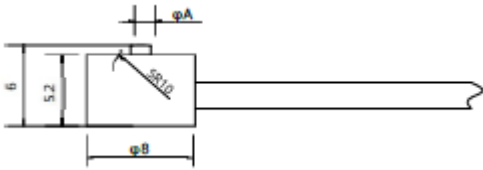

(kg)	A
1/2/3/5/10/20	1.6
50/100	2.3

Force mode



Technical parameters			
Measuring range	1/2/3/5/10/20/50/100 kg	Sensitivity temperature effect	±0.25%F.S/10°C
Composite Error	≤±1%	Zero temperature effect	±0.25%F.S/10°C
Non-linear	1%	Temperature compensation range	-10~60°C
Sensitivity	1.0/2.0±10% <i>mV/V</i>	Operating temperature range	-20~80°C
Creep	±0.5%F.S/30min	Excitation voltage	5~10V
Zero output	±2.0% F.S	SAFE overload range	150%F.S
Input impedance	350±5/800~1100Ω	Limit Overload Range	200%F.S
Output impedance	350±3/800~1100Ω	Cable specifications	Φ2mm×2m
Insulation Resistance	≥5000MΩ/100V DC	Protection level	Ip66



KDEV-L-F05

Customizable:  high temperature

Product characteristics

- The micro-sensor is made of special materials for sensors and has an ultra-thin thickness. It is widely used in industrial, R & D and other fields of measurement and control.

Mounting dimensions

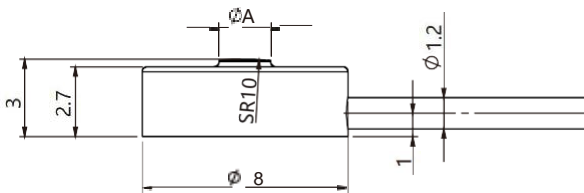

(kg)	ΦA
2/5/10/20	2
30/50/100	2.3

Force mode



Technical parameters			
Measuring range	2/5/10/20/30/50/100 kg	Sensitivity temperature effect	±0.15%F.S/10°C
Composite Error	±1%F.S.	Zero temperature effect	±0.15%F.S/10°C
Non-linear	1%F.S.	Temperature compensation range	-10~40°C
Sensitivity	1.0/2.0±10% <i>mV/V</i>	Operating temperature range	-20~60°C
Lag behind	0.2%F.S	Excitation voltage	5~10V
Service life	Over 1 million times	Maximum excitation voltage	12V
Materials	stainless steel	SAFE overload range	120%F.S
Cable specifications	Φ1.2mm×3m	Limit Overload Range	150%F.S
Insulation Resistance	≥5000MΩ/100V DC	Protection level	Ip66



KDEV-L-F06

Customizable:  high temperature

Product characteristics

- Made of high-quality stainless steel, small size, high precision, stable structure. It is convenient to be installed in narrow space and widely used in automatic equipment and other fields.

Mounting dimensions

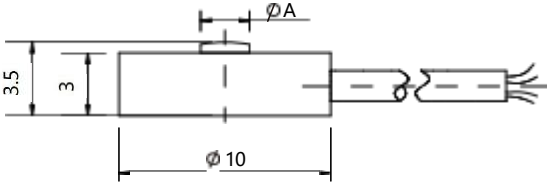

(kg)	ΦA
2/5/10/20	2
30/50/100	2.3

Force mode



Technical parameters

Measuring range	2/5/10/20/50/100 kg	Sensitivity temperature effect	±0.25%F.S/10°C
Composite Error	≤±1%	Zero temperature effect	±0.25%F.S/10°C
Non-linear	1%	Temperature compensation range	-10~60°C/-20~120°C
Sensitivity	1.0/2.0±10% <i>mV/V</i>	Operating temperature range	-20~80°C/-40~160°C
Creep	±0.25%F.S/30min	Excitation voltage	5~10V
Zero output	±2.0%F.S	SAFE overload range	120%F.S
Input impedance	350±5/800~1100Ω	Limit Overload Range	150%F.S
Output impedance	350±3/800~1100Ω	Cable specifications	Φ1.2mm×3m
Insulation Resistance	≥5000MΩ/100V DC	Protection level	Ip66



KDEV-L-F11

Customizable:  high temperature  waterproof

Product characteristics

- The sensor is made of strain structure, small size, low height and all stainless steel. Customizable high-temperature performance, suitable for auto press assembly, automatic assembly, 3C product test, New Energy Product Assembly, medical inspection, robotics, and other industrial test and control systems.

Mounting dimensions

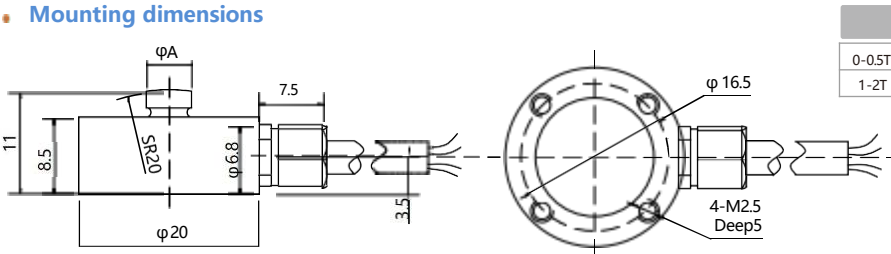

Force mode



Technical parameters

Measuring range	2/5/10/20/50 kg, 0.1/0.2/0.5/1/2T	Sensitivity temperature effect	±0.05%F.S/10°C
Composite Error	≤±0.3%	Zero temperature effect	±0.05%F.S/10°C
Non-linear	0.3%	Temperature compensation range	-10~60°C
Sensitivity	1.0/2.0±20% <i>mV/V</i>	Operating temperature range	-20~80°C
Creep	±0.5%F.S/30min	Excitation voltage	5~12V
Zero output	±2.0%F.S	SAFE overload range	150%F.S
Input impedance	350±5/800~1100Ω	Limit Overload Range	200%F.S
Output impedance	350±10/800~1100Ω	Cable specifications	Φ3mm×3m
Insulation Resistance	≥5000MΩ/100V DC	Protection level	Ip66



KDEV-L-F12

Customizable:  high temperature  waterproof

Product characteristics

- Customizable high-temperature performance, for injection molding, extrusion and other manufacturing processes, for automotive assembly, automated assembly, 3C product testing, New Energy Product Assembly, medical testing, robotics, other industrial test control systems.

• Mounting dimensions

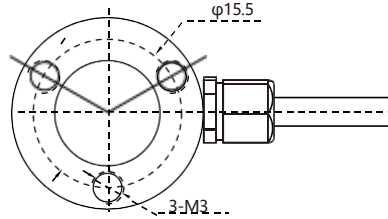
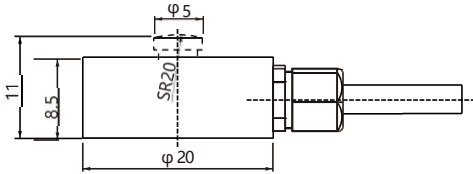

• Force mode

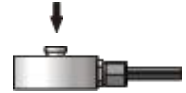

Technical parameters

Measuring range	3/5/10/20/30/50/100 kg	Insulation resistance	≥2000MΩ/50V DC
Output sensitivity	1.0/1.5mV/V	Temperature sensitivity drift	±0.05%F.S/10°C
Zero output	±2.0%F.S	Temperature compensation range	±0.05%F.S/10°C
Creep	0.1%F.S	Excitation voltage	5~10V
Non-linear	0.3%F.S	Maximum excitation voltage	15V
Lag behind	0.3%F.S	Temperature compensation range	-10~60°C
Repeatability	0.05%F.S	Operating temperature range	-20~80°C
Input Resistance	350±5Ω	SAFE overload	120%F.S
Output Resistance	350±5Ω	Ultimate overload	200%F.S
Cable specifications	Φ3mm×3m	Protection level	Ip66



KDEV-L-F14

Customizable:  high temperature

Product characteristics

- Low height, small deformation, small size, high dynamic response frequency, large stress area, customizable high temperature performance. For injection molding, backlogs and other manufacturing processes, suitable for automotive press assembly, automatic assembly, 3C product testing.

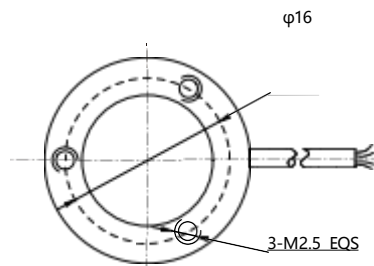
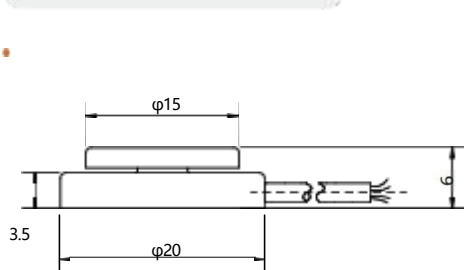

• Force mode

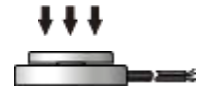

Technical parameters

Measuring range	2/5/10/20/30/50 kg	Sensitivity temperature effect	±0.05%F.S/10°C
Composite Error	≤±0.5%	Zero temperature effect	±0.05%F.S/10°C
Non-linear	0.5%	Temperature compensation range	-10~60°C/-20~120°C
Sensitivity	1.0/2.0±20% mV/V	Operating temperature range	-20~80°C/-40~160°C
Creep	±0.5%F.S/30min	Excitation voltage	5~12V
Zero output	±2.0% F.S	SAFE overload range	150%F.S
Input impedance	350±5/800~1100Ω	Limit Overload Range	200%F.S
Output impedance	350±10/800~1100Ω	Cable specifications	Φ1.2mm×3m
Insulation Resistance	≥5000MΩ/100V DC	Protection level	Ip66



KDEV-L-F16

Customizable:  high temperature  waterproof

Product characteristics

- Small size, light weight, all stainless steel material, corrosion resistance. Suitable for the occasion of limited space. It is mainly used in automobile pressing assembly, automatic assembly, 3C product test, New Energy Product Assembly, medical inspection, robot field, etc. .

Mounting dimensions

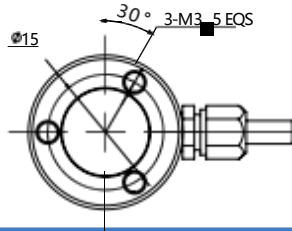
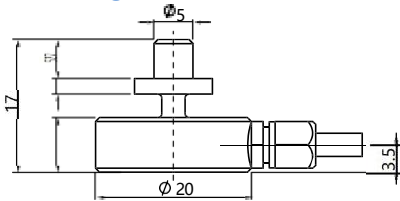

Force mode

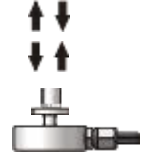

技术参数 / Technical parameters

Measuring range	0-5/10/20/30/50/100 kg	Insulation resistance	≥5000MΩ/100V DC
Output sensitivity	1.5±10%mV/V	Temperature sensitivity drift	±0.1%F.S/10°C
Zero output	±1%m/V/V	Temperature compensation range	±0.1%F.S/10°C
Creep	≤0.1%F.S	Excitation voltage	5~12V
Non-linear	≤0.3%F.S	Maximum excitation voltage	15V
Lag behind	≤0.3%F.S	Temperature compensation range	-10~40°C
Repeatability	≤0.1%F.S	Operating temperature range	-20~60°C
Input Resistance	800~1100Ω	SAFE overload	150%F.S
Output Resistance	800~1100Ω	Ultimate overload	200%F.S
Cable specifications	Φ3mm×3m	Material	stainless steel



KDEV-L-F2

Product characteristics

- Using high-precision resistance strain type principle, stainless steel materials, sealed welding, oil-proof, waterproof, corrosion-resistant. Safe explosion-proof products, can be used in harsh environment and dangerous occasions. Small size, high dynamic response frequency.

Mounting dimensions

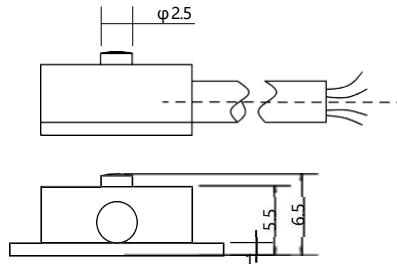
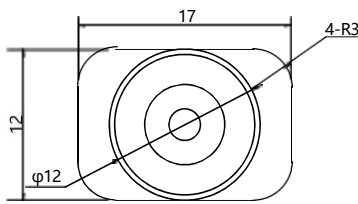

Force mode

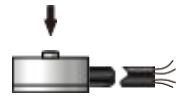

Technical parameters

Measuring range	20-50 kg	Sensitivity temperature effect	±0.05%F.S/10°C
Composite Error	≤±0.3%	Zero temperature effect	±0.05%F.S/10°C
Non-linear	0.3%	Temperature compensation range	-10~60°C
Sensitivity	1.0/2.0±15%mV/V	Operating temperature range	-20~80°C
Creep	±0.5%F.S/30min	Excitation voltage	5~12V
Zero output	±2.0%F.S	SAFE overload range	150%F.S
Input impedance	350±10/800~1100Ω	Limit Overload Range	200%F.S
Output impedance	350±10/800~1100Ω	Cable specifications	Φ2mm×3m
Insulation Resistance	≥5000MΩ/100V DC	Protection level	Ip66



KDEV-L-F4

Product characteristics

- Micro sensor, low height, small deformation, stainless steel material, high dynamic response frequency, mainly used in automation industry, robot grasping, pressing, tension pressure detection and control, automobile assembly force value detection.

Mounting dimensions

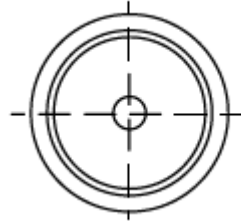
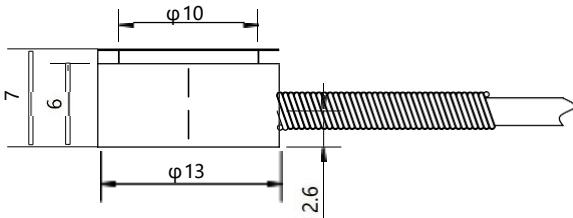

Force mode

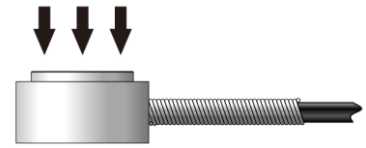

Technical parameters

Measuring range	10/20 kg	Sensitivity temperature effect	$\pm 0.05\%F.S./10^{\circ}C$
Composite Error	$\leq \pm 0.5\%$	Zero temperature effect	$\pm 0.05\%F.S./10^{\circ}C$
Non-linear	0.5%	Temperature compensation range	-10~60°C
Sensitivity	1.2 $\pm 10\%$ mV/V	Operating temperature range	-20~80°C
Creep	$\pm 0.5\%F.S./30min$	Excitation voltage	5~12V
Zero output	$\pm 0.5\%F.S$	SAFE overload range	150%F.S
Input impedance	350 $\pm 10\Omega$	Limit Overload Range	200%F.S
Output impedance	350 $\pm 10\Omega$	Cable specifications	$\Phi 2mm \times 3m$
Insulation Resistance	$\geq 5000M\Omega/100V$ DC	Protection level	Ip66



KDEV-L-G1

Customizable:  high temperature

Product characteristics

- Small size, large range, small deformation, special stainless steel material for sensor. It is widely used in many fields such as industry, R & D, automatic manufacture and so on.

Mounting dimensions

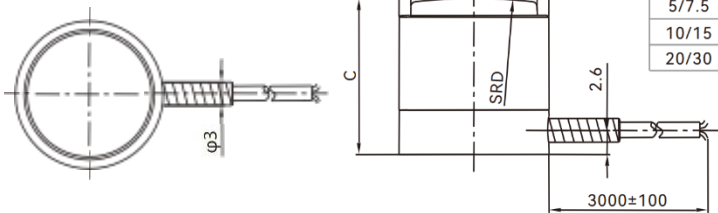

Force mode

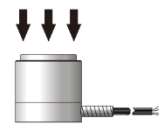

Technical parameters

Measuring range)	1/2/5/7.5/10/15/20/30 T	Sensitivity temperature effect	$\pm 0.05\%F.S./10^{\circ}C$
Composite Error	$\leq \pm 0.5\%$	Zero temperature effect	$\pm 0.05\%F.S./10^{\circ}C$
Non-linear	0.5%	Temperature compensation range	-10~60°C
Sensitivity	1.0/2.0 $\pm 10\%$ mV/V	Operating temperature range	-20~80°C
Creep	$\pm 0.5\%F.S./30min$	Excitation voltage	5~15V
Zero output	$\pm 2.0\%F.S$	SAFE overload range	200%F.S
Input impedance	380 $\pm 20\Omega$	Limit Overload Range	300%F.S
Output impedance	350 $\pm 10\Omega$	Cable specifications	$\Phi 2mm \times 3m$
Insulation Resistance	$\geq 5000M\Omega/100V$ DC	Protection level	Ip65