

Unpacking and Installation Guide

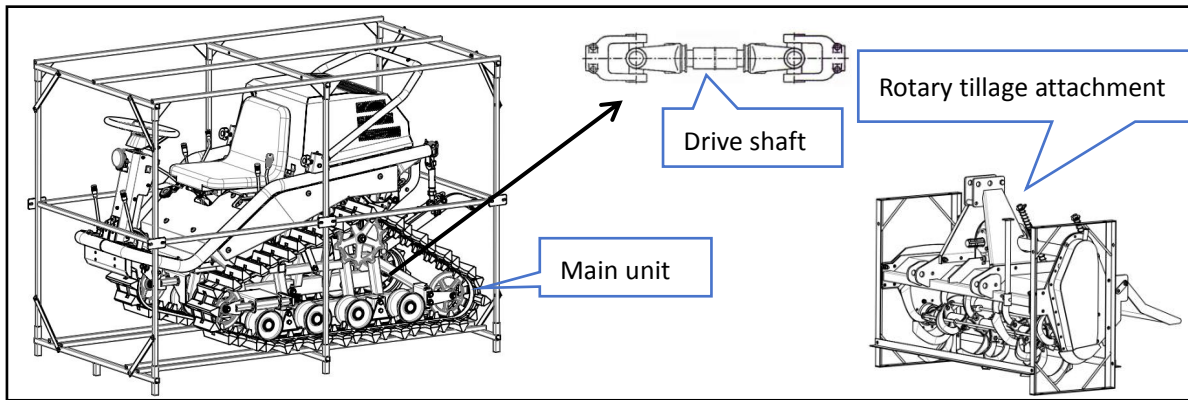

Step 1: Dismantle the iron frame

- ① Open the iron frame of the main unit → Take out the drive shaft → Start the machine → Drive the machine out of the iron frame
- ② Open the iron frame of rotary tillage attachment → Take it out

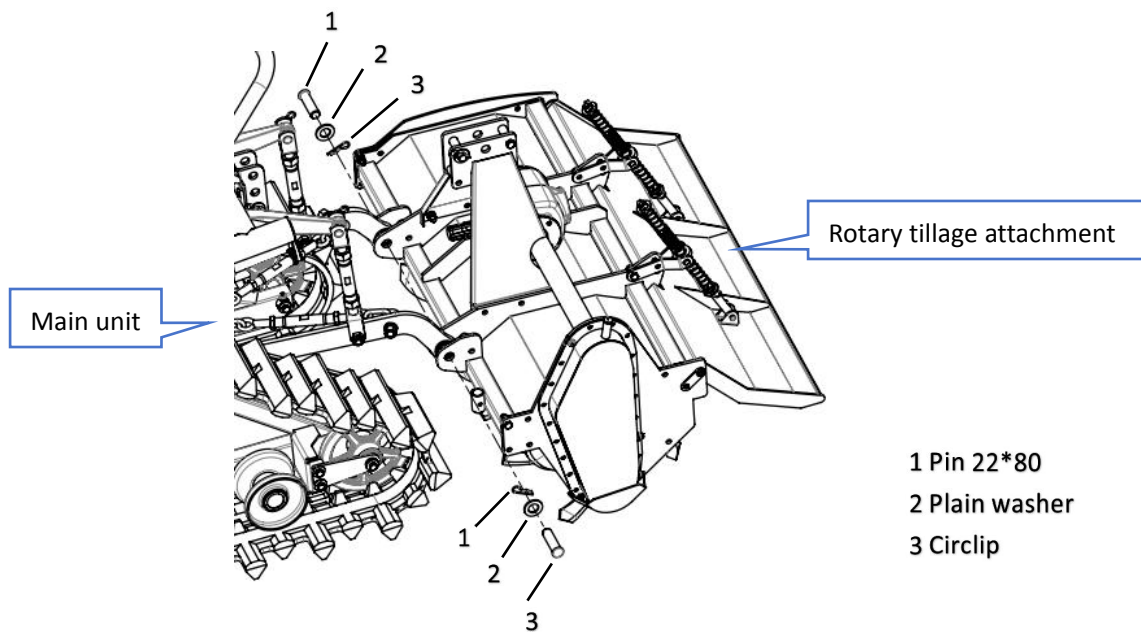

Step 2: Connect the rotary tillage attachment

- ① Place the rotary tillage attachment behind the main machine.
- ② Insert pins 22*80 at left and right ends respectively and limit the position with plain washers and circlips.



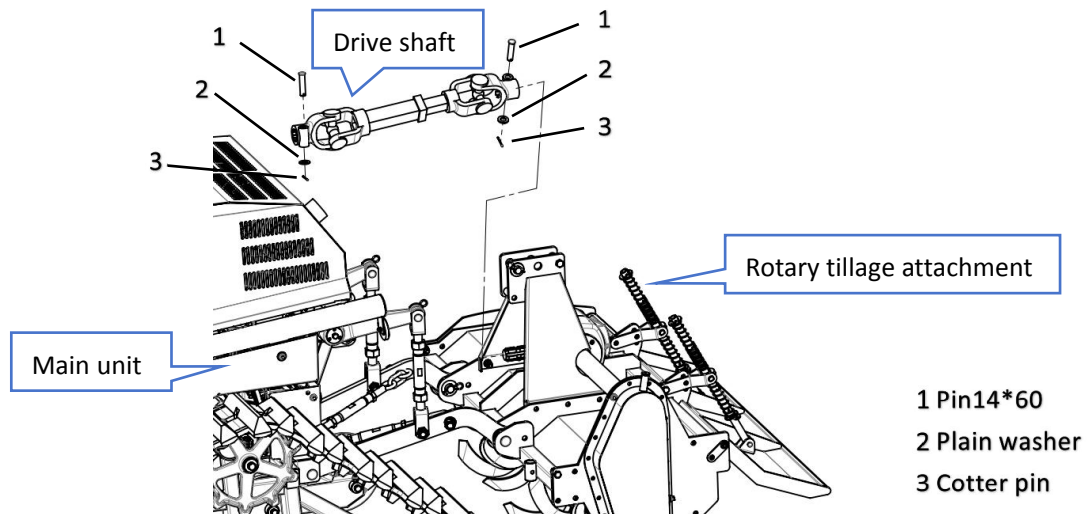

Step 3: Install the drive shaft

- ① The drive shaft is divided into two parts, respectively connected to the main machine and the rotary tillage attachment, inserted into the pin 14*60, and limited by plain washers and cotter pins.
- ② Insert the square shaft of drive shaft into the square tube.

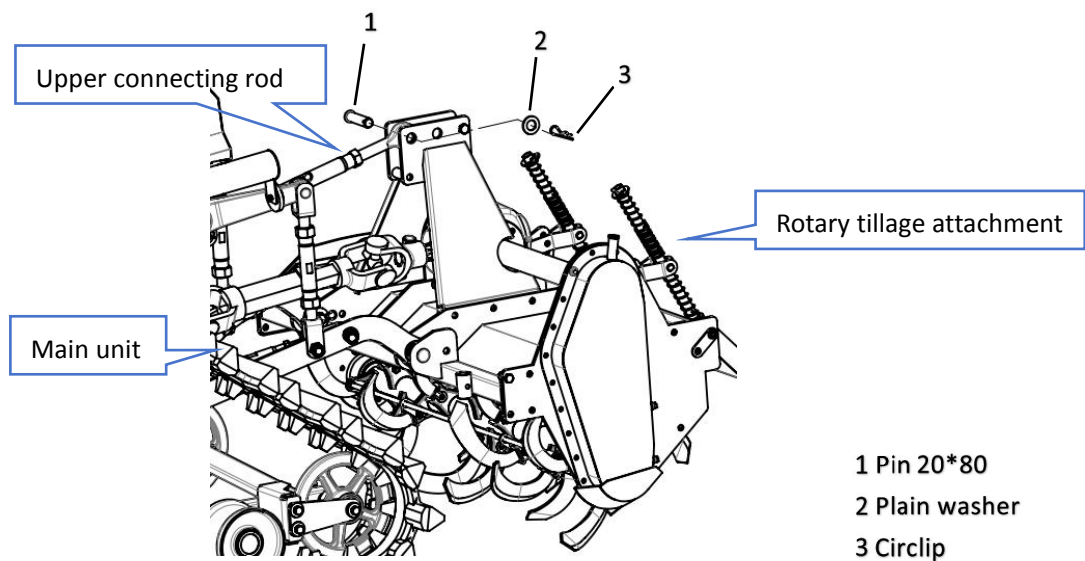

Step 4: Install the upper connecting rod

- ① Insert the pin 20*80 to connect the upper connecting rod to the rotary tillage attachment.
- ② Limit with plain washers and circlips.