

## RS7227 Series 2-Channel PCBA

### Description

RS7227 series product is a 2-channel encoder PCBA solution designed for stepper motors, DC motors and so on. The outer diameter is suitable for 385 motors, with our special code disc, the typical model RS7227-96 can output 96 pulses A, B signal, which can be used in special sewing machines, CNC machine tools, robots, automation equipment and so on.



### Ordering Information

RS7227 series is available in a variety of options as follows:

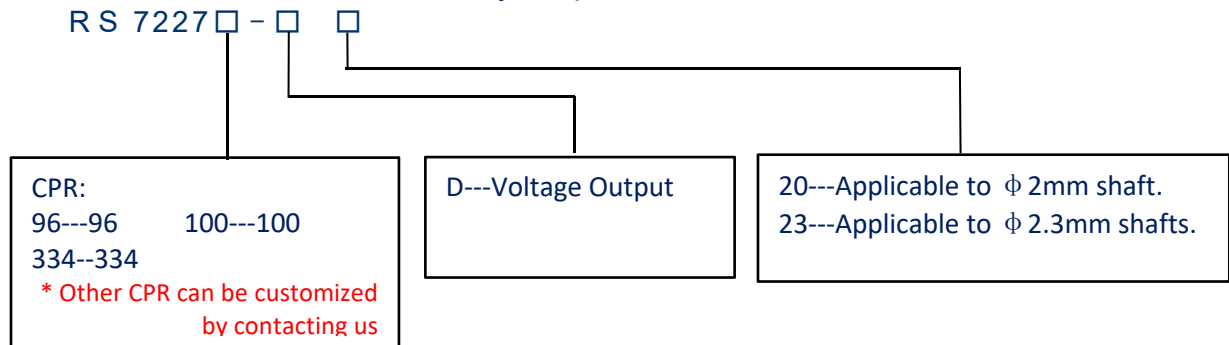

### External Dimension

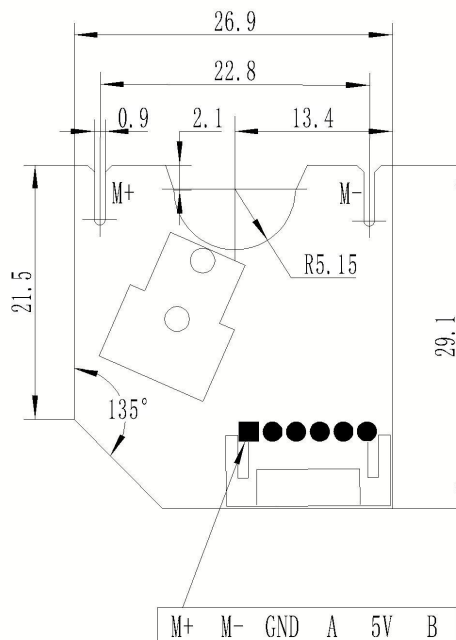

Note: Plug type spacing 2.0mm 6P

## Installation Diagram

