

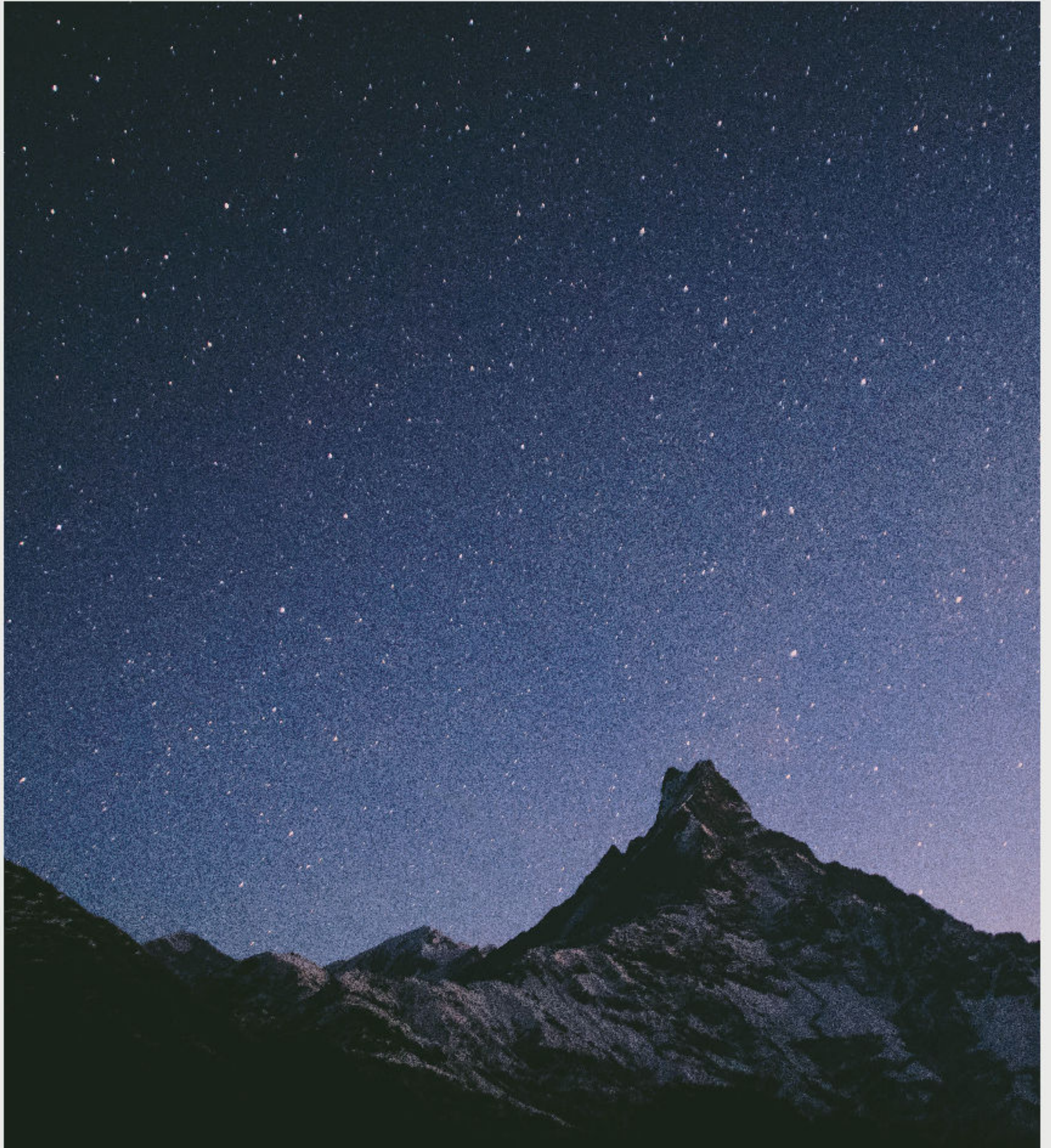

CONSTELLATION SPACE CAPSULE PRODUCT BROCHURE

太空舱产品宣传册



金华中兴通信技术有限公司

「 目 录 」

2	公司简介 COMPANY PROFILE
2	产品概览 PRODUCT OVERVIEW
3	I05 PRODUCT INTRODUCTION
4	I06 PRODUCT INTRODUCTION
5	I07 PRODUCT INTRODUCTION
6	I09 PRODUCT INTRODUCTION
7	I02 PRODUCT INTRODUCTION
8	I08 PRODUCT INTRODUCTION

金华中兴通信技术有限公司是一家研制、开发、生产、安装户外机房、户外机柜、活动方舱、应急通信设备、通信杆塔等通信基站及数据中心、环境、交通、电力、气候监测站点户外配套设施的专业公司。公司具备钢结构工程专业承包三级、通信工程总承包三级资质，广电通信塔桅生产许可证。拥有完整的户外机房机柜（方舱）、塔桅生产线，年生产集成能力超过一万台套。竭诚地为国内外通信运营商、数据集成商、环境监测厂商及其它客户，提供立体、全方位的产品生产及工程交付、运行维护等技术服务。

公司下设市场营销中心、技术质量中心、生产管理中心、运营管理中心。公司员工300余人，其中：中高级技术管理人员50余人，中、高级技术工人150余人；拥有30余支技术熟练的专业安装维护队伍。

专注的精神、专心的态度造就了我们专业的品质，为客户及社会高度负责的使命感，成就了我们持续不断的改进和创新的能力。近二十年来我们已累计为国内外通信运营商、数据集成商、环境监测厂商、及其它客户，提供了超过数十万套户外机房（机柜）及其相关配套设施。积累了相当丰富的从业经验，并形成了一套完善的工程技术服务机制及可以满足用户不同需求的系列产品。

Jinhua ZhongXing Communication Technology Co., LTD, specialize in Outdoor shelter, Cabinet, Modular house for Telecom, environmental monitoring, Computer data center, Energy storage applications, we've got a one-stop supply from the product design, integrated solution, production, construction to marketing. We are committed to provide first-class quality and efficient pre-sale, after-sale services, which has taken good reputations from our customers.

Our company is certified with "Steel Construction professional contractor III", "Grade 3 of general contracting on Telecom engineering", "Production license for broadcast TV tower", we have full capability to deliver products with rich field installation experience, the production capacity >10,000 sets/year.

105

星宿

SPACE CAPSULE HOUSE

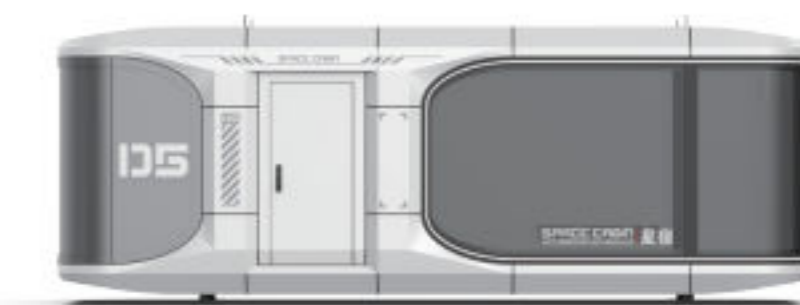

106

星宿

SPACE CAPSULE HOUSE



107

星宿

SPACE CAPSULE HOUSE

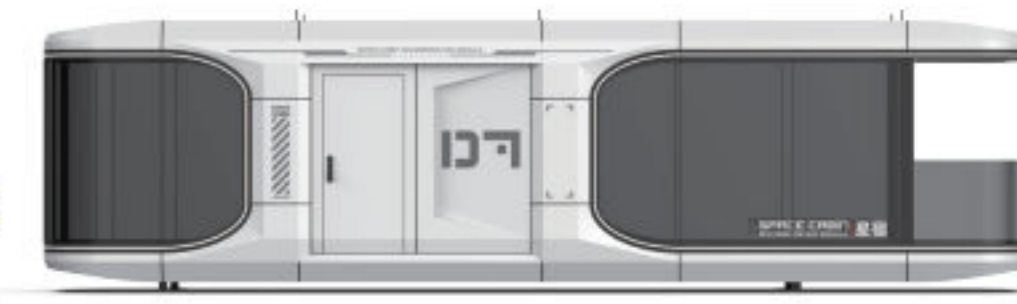

109

星宿

SPACE CAPSULE HOUSE



102

星宿

SPACE CAPSULE HOUSE



108

星宿

SPACE CAPSULE HOUSE



PRODUCT INTRODUCTION

产品介绍



星宿 | SPACE CABIN
ACCOMMODATION MODULE

SPACE CABIN

DS



星宿

SPACE CABIN
ACCOMMODATION
MODULE

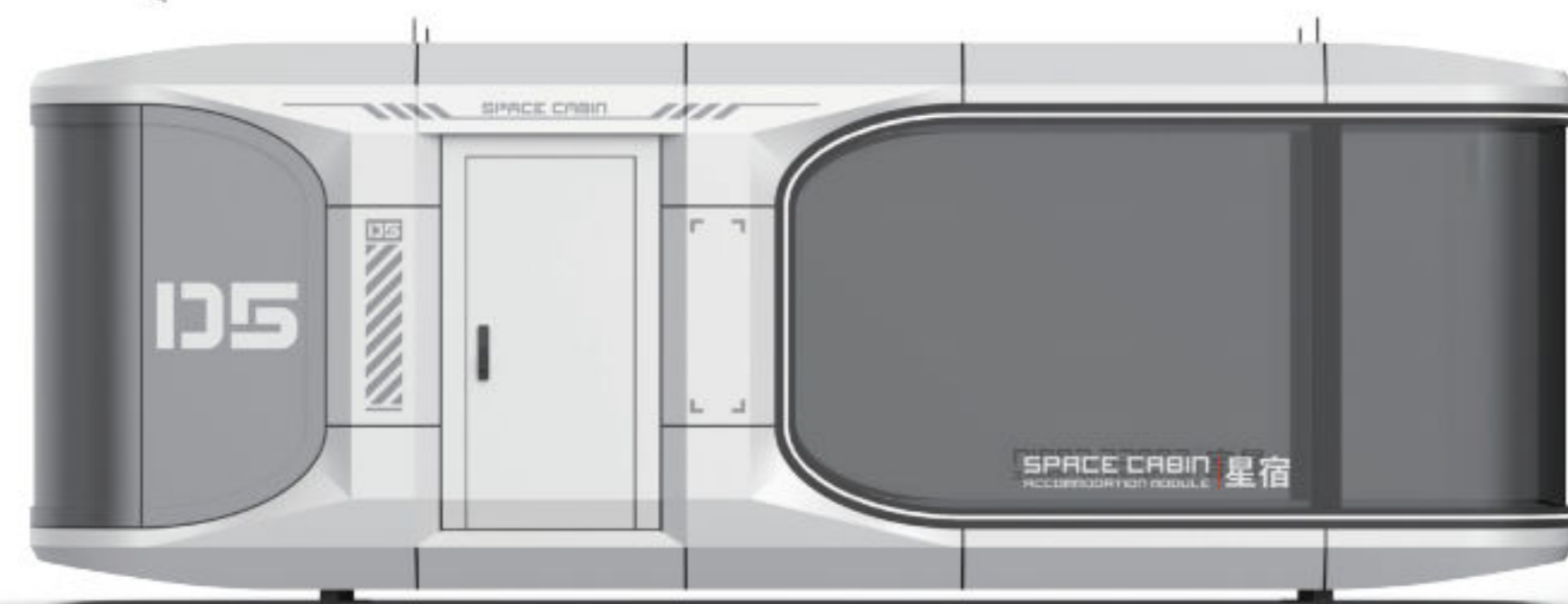





星宿 | SPACE CABIN
ACCOMMODATION MODULE



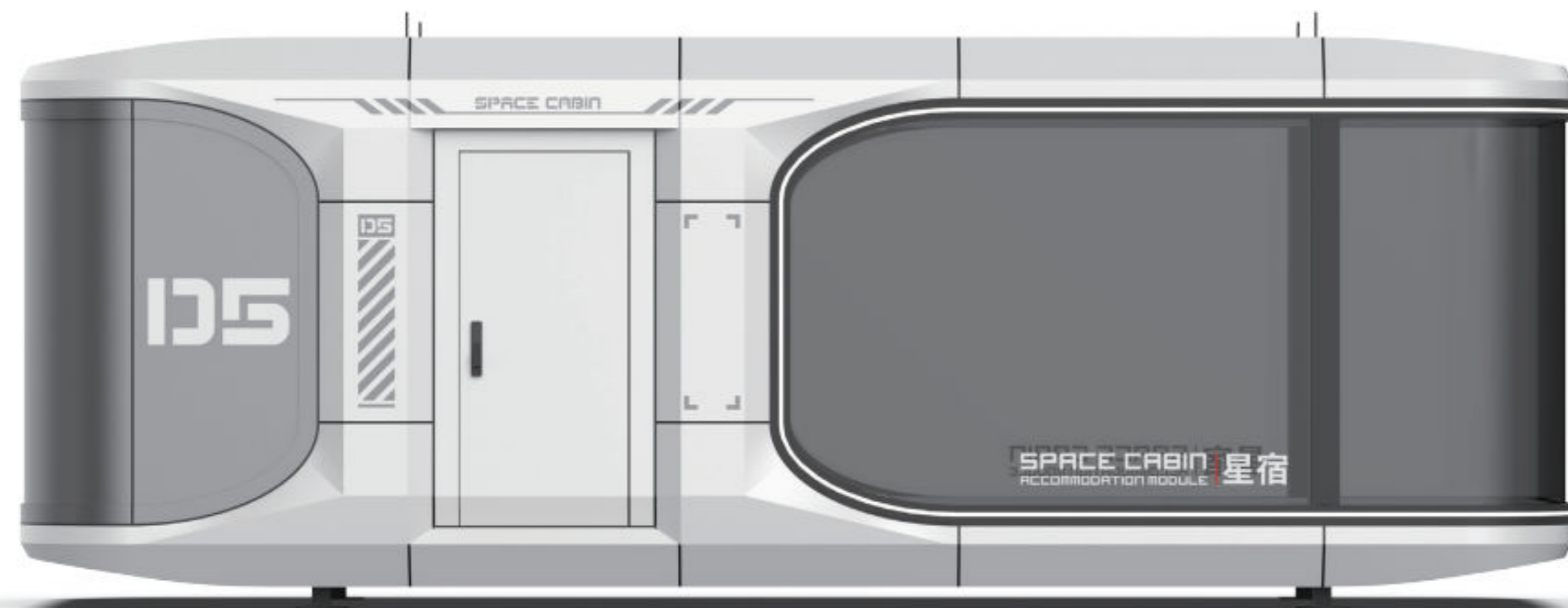

*以实物为准/Subject to The Actual Product

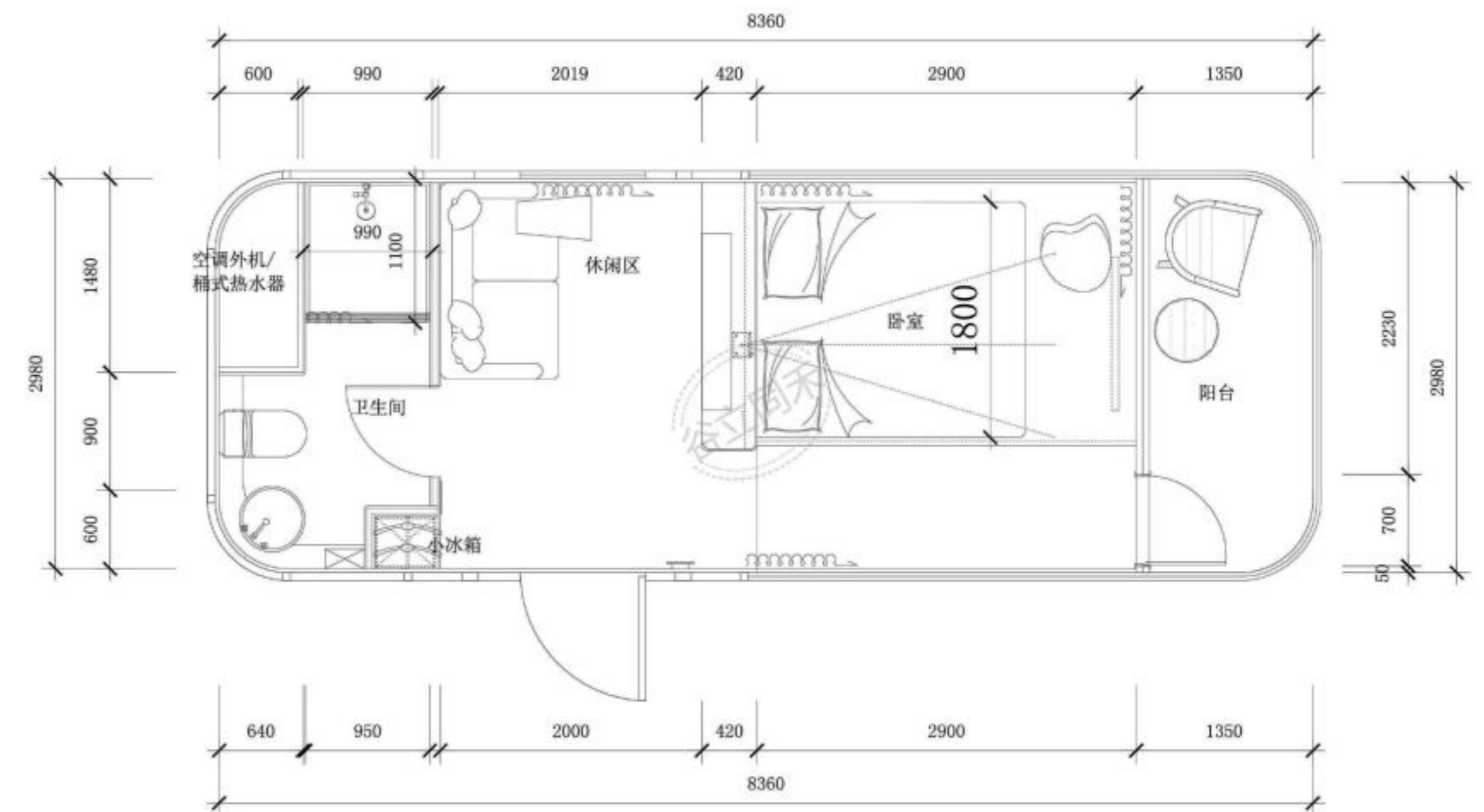

产品信息 (Configuration instructions)	
外形尺寸 Dimensions	8500mm*3300mm*3300mm
占地面积 Floor Area	28.4m ²
入住人数 Occupancy	2人
用电功率 Power consumption	12KW
约总重量 Approximate total weight	5吨

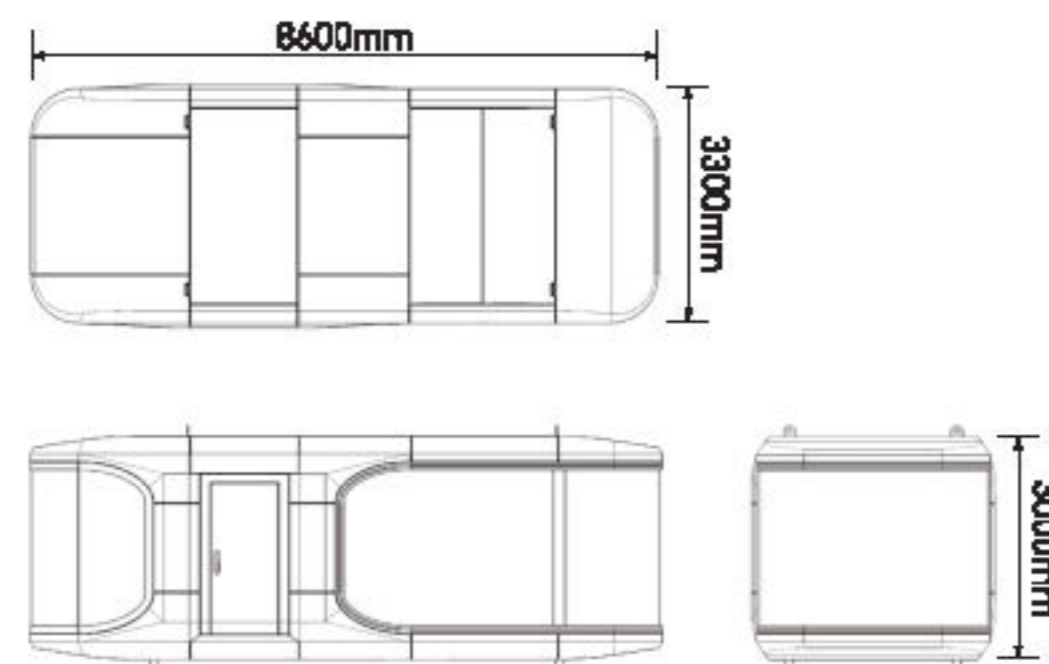

主体外结构 (Extracorporeal structure)		
No.	结构 (Structure)	材料 (Material)
1	钢结构框架 Steel structure frame	钢结构框架 Steel structure frame
2	外墙面板 Exterior wall panels	铝制 Aluminum
3	隔热保温 Heat insulation	100mm聚氨酯保温层 100mm polyurethane insulation layer
4	外墙玻璃 External wall glass	6+18A+6中空LOW-E玻璃或6+6夹胶隔热玻璃 6+18A+6 hollow LOW-E glass or 6+6 amine insulating glass
5	外壳表面处理 Shell surface treatment	金属氟碳漆烤漆 Metal fluorocarbon paint baking paint
6	阳台 Balcony	全景阳台(10mm钢化玻璃) Panoramic balcony (10mm tempered glass)
7	外围灯带 Peripheral light strip	外围灯带(环绕氛围灯带) Peripheral light strip (surrounding ambient light strip)
8	入户门 Entrance door	智能门禁系统 Intelligent access control system

舱内环保精装修 (Eco-friendly fine decoration inside Structural materials)		
No.	结构 (Structure)	材料 (Material)
9	天花板 Ceiling	可饰面一体板 Can be decorated with integrated board
10	墙面 Wall surface	可饰面一体板 Can be decorated with integrated board
11	地面 Floor	高级木纹锁扣地板 High-grade wood grain lock floor
12	室内灯效 Indoor lighting effect	3000K暖黄光 3000K warm yellow light
13	室外灯效 Outdoor lighting effect	4000K暖白光 4000K warm white light
14	窗帘 Curtain	电动窗帘 Electric curtain
15	指控系统 Control system	全屋集成智控系统 The whole house integrated intelligent control system
16	插座面板 Socket panel	品牌开关面板 Brand switch panel

全屋设备 (Whole house equipment)		
No.	结构 (Structure)	材料 (Material)
17	空调 Air conditioner	格力风管式空调 Gree ducted air conditioner
18	浴霸 Yuba	风暖式三合一集成浴霸 Air-heated three-in-one integrated bathroom

卫浴五金(Bathroom Fittings)		
No.	结构 (Structure)	材料 (Material)
19	卫生间隐私门 Bathroom privacy door	磨砂钢化玻璃 Frosted tempered glass
20	挂衣架毛巾架 Hanger Towel Rack	挂衣架毛巾架 Hanger Towel Rack
21	花洒 Shower	50L桶式热水器 50L bucket water heater
22	台盆 Basin	台上盆 Above counter basin
23	马桶 Toilet	智能马桶 Smart toilet
24	水龙头 Faucet	高脚水龙头 Tall faucet

其他配件(Other Accessories)	
No.	结构 (Structure)
25	运输固定件/连接件 Shipping Fixtures/Connectors
26	插卡通电/取卡通电 Plug in card power/take card power

选配配件(Optional accessories)	
No.	结构 (Structure)
27	地暖:电地暖 Floor heating: Electric floor heating
28	管道防冻:电伴热 Pipeline antifreeze: electric heat tracing
29	影音设备:投影仪 Audio-visual equipment: Projector
30	天窗 Skylight
31	循环换气系统 Circulation ventilation system
32	安全报警:烟感 Security alarm: smoke
33	多情景模式功能面板 Multi-scene mode function panel
34	照明智能控制 Intelligent lighting control
35	窗帘智能控制 Intelligent curtain control
36	智能语音系统 Intelligent voice system
37	酒店链接系统 Hotel link system







136

136 星宿

星宿 | SPACE CABIN
ACCOMMODATION MODULE

多姆斯星宿



星宿

SPACE CABIN
ACCOMMODATION
MODULE

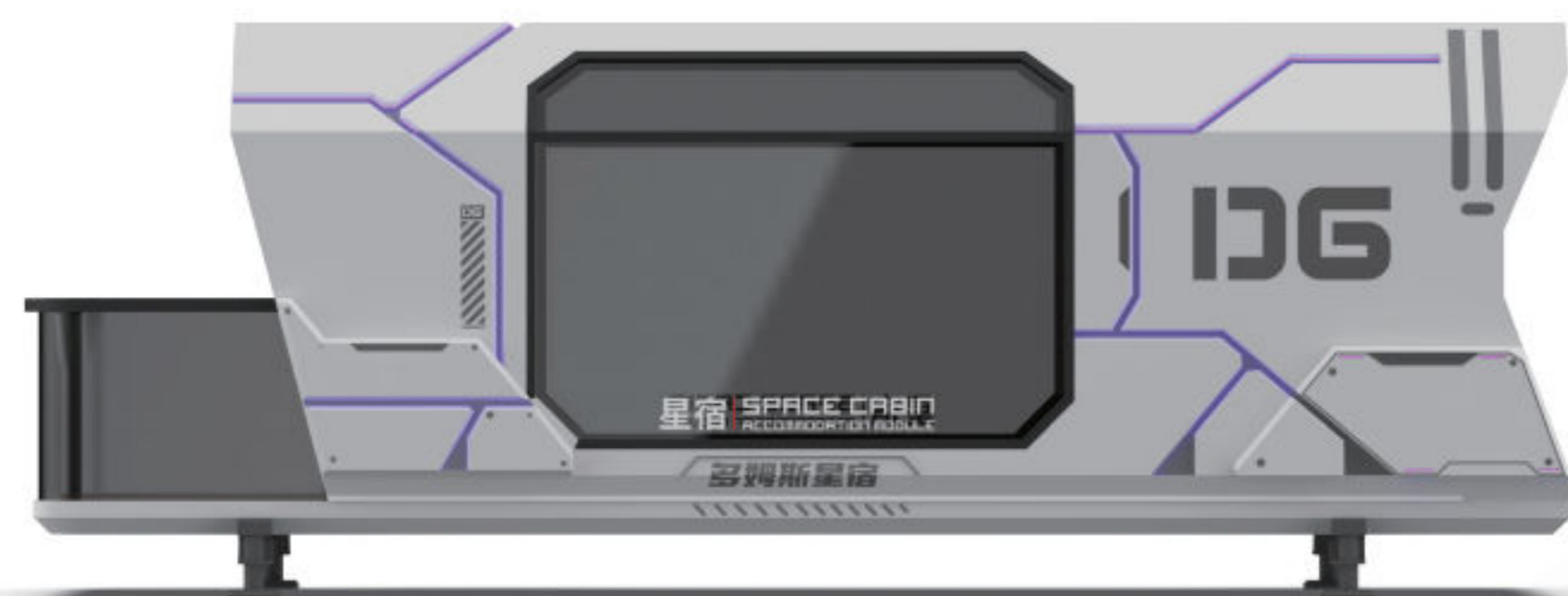



PRODUCT INTERIOR

产品内饰

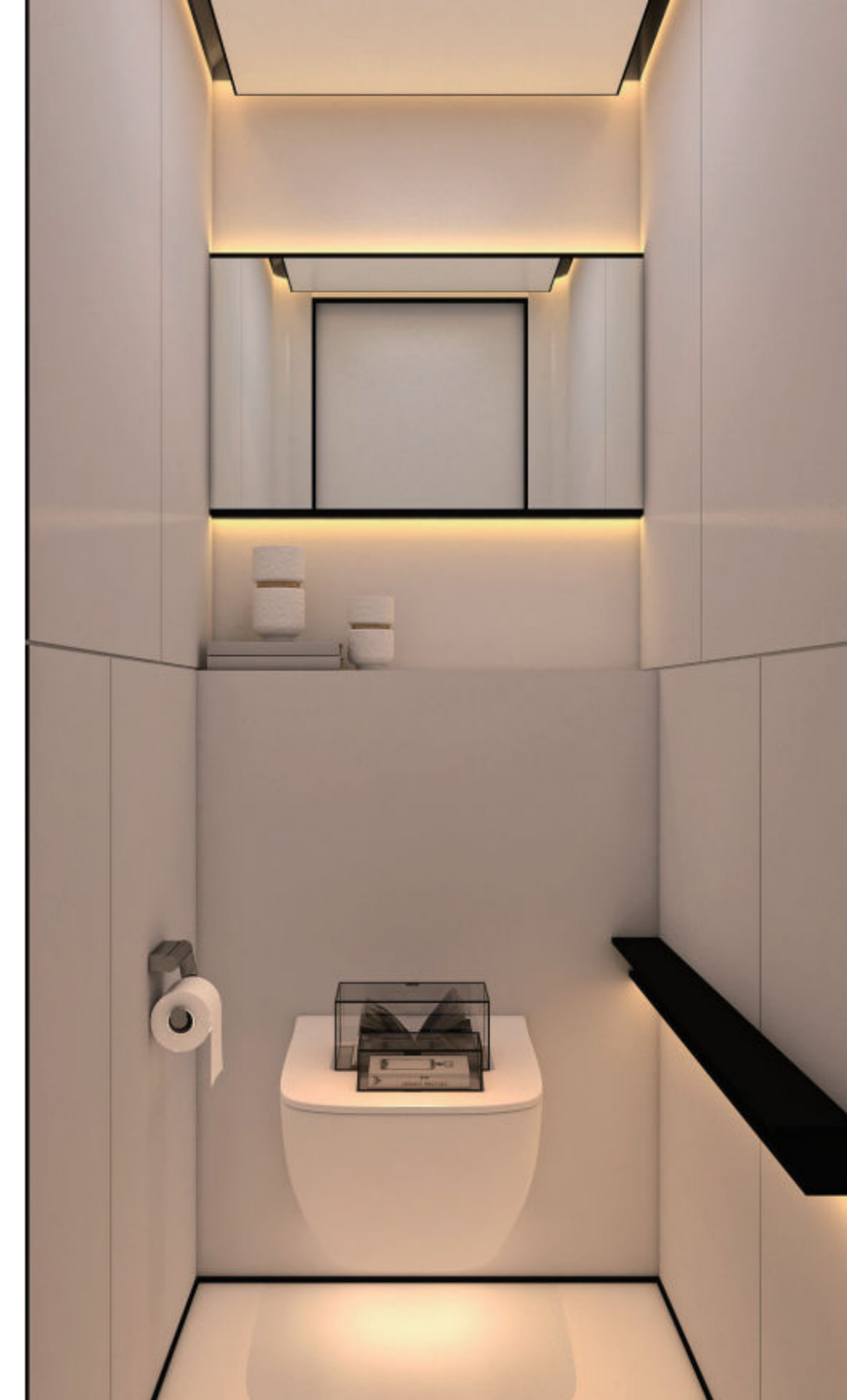

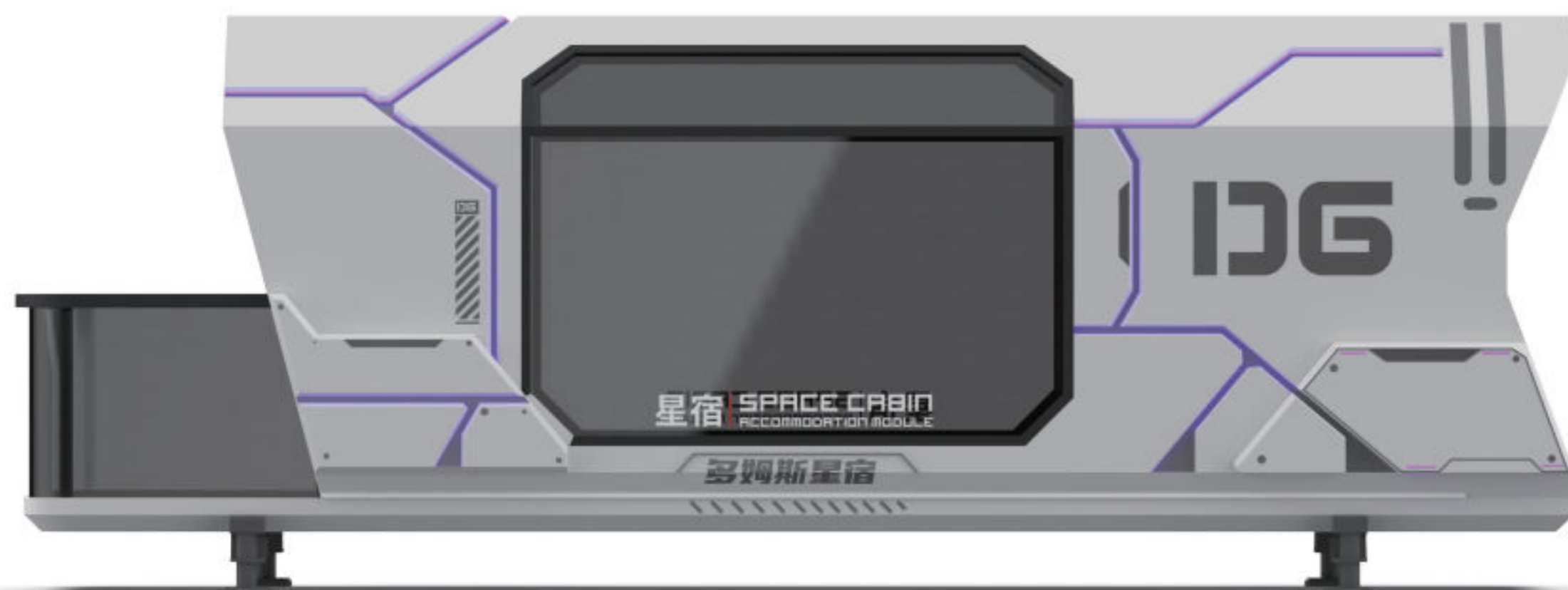

*以实物为准

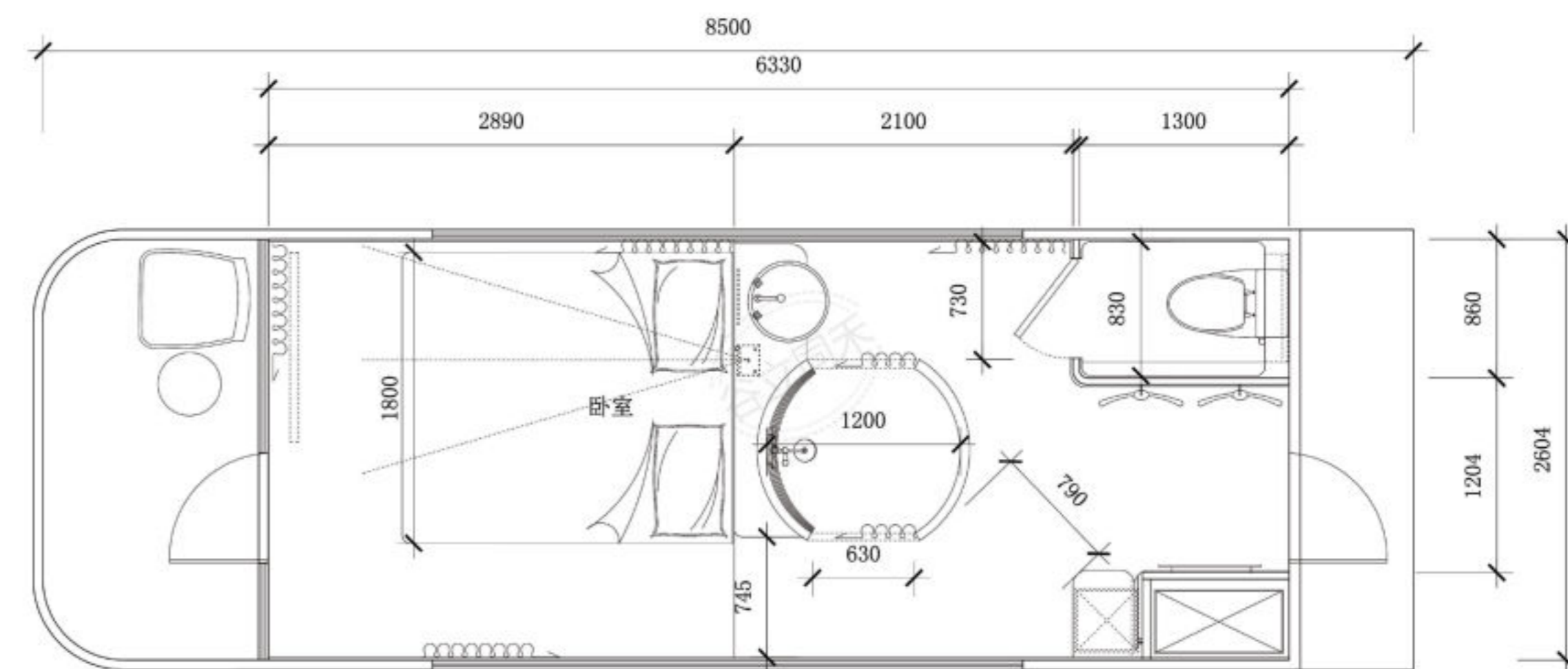

产品信息 (Configuration instructions)	
外形尺寸 Dimensions	8500mm*3300mm*3300mm
占地面积 Floor Area	28.4m ²
入住人数 Occupancy	2人
用电功率 Power consumption	12KW
约总重量 Approximate total weight	5吨

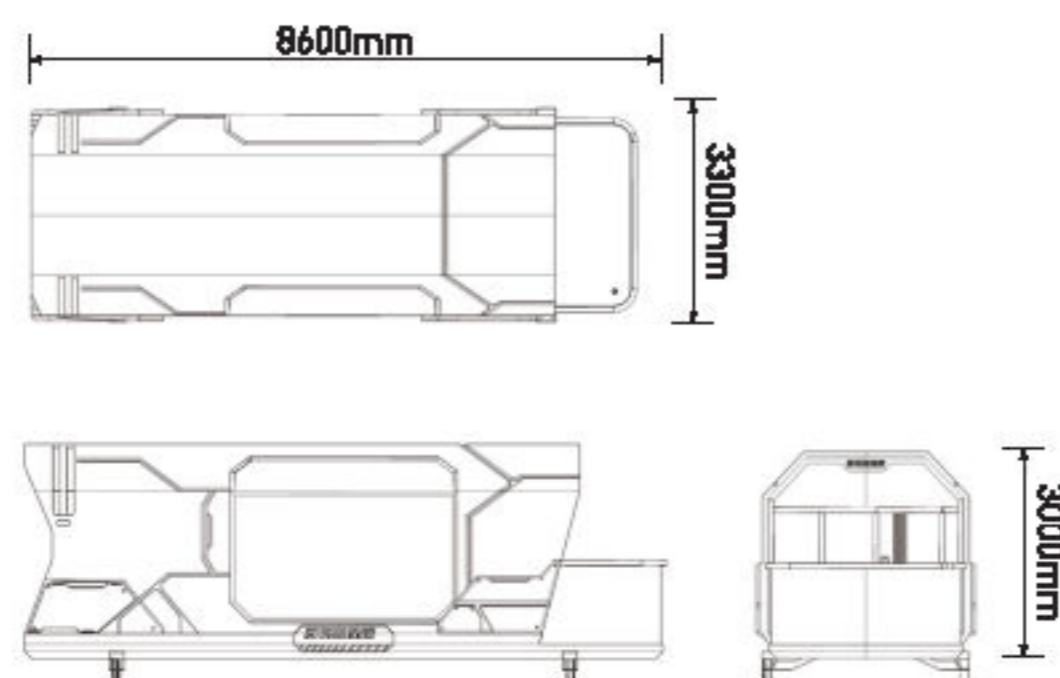

主体外结构 (Extracorporeal structure)		
No.	结构 (Structure)	材料 (Material)
1	钢结构框架 Steel structure frame	钢结构框架 Steel structure frame
2	外墙面板 Exterior wall panels	铝制 Aluminum
3	隔热保温 Heat insulation	100mm聚氨酯保温层 100mm polyurethane insulation layer
4	外墙玻璃 External wall glass	6+18A+6中空LOW-E玻璃或6+6夹胶隔热玻璃 6+18A+6 hollow LOW-E glass or 6+6 amine insulating glass
5	外壳表面处理 Shell surface treatment	金属氟碳漆烤漆 Metal fluorocarbon paint baking paint
6	阳台 Balcony	全景阳台(10mm钢化玻璃) Panoramic balcony (10mm tempered glass)
7	外围灯带 Peripheral light strip	外围灯带(环绕氛围灯带) Peripheral light strip (surrounding ambient light strip)
8	入户门 Entrance door	智能门禁系统 Intelligent access control system

舱内环保精装修 (Eco-friendly fine decoration inside Structural materials)		
No.	结构 (Structure)	材料 (Material)
9	天花板 Ceiling	可饰面一体板 Can be decorated with integrated board
10	墙面 Wall surface	可饰面一体板 Can be decorated with integrated board
11	地面 Floor	高级木纹锁扣地板 High-grade wood grain lock floor
12	室内灯效 Indoor lighting effect	3000K暖黄光 3000K warm yellow light
13	室外灯效 Outdoor lighting effect	4000K暖白光 4000K warm white light
14	窗帘 Curtain	电动窗帘 Electric curtain
15	指控系统 Control system	全屋集成智控系统 The whole house integrated intelligent control system
16	插座面板 Socket panel	品牌开关面板 Brand switch panel

全屋设备 (Whole house equipment)		
No.	结构 (Structure)	材料 (Material)
17	空调 Air conditioner	格力风管式空调 Gree ducted air conditioner
18	浴霸 Yuba	风暖式三合一集成浴霸 Air-heated three-in-one integrated bathroom

卫浴五金(Bathroom Fittings)		
No.	结构 (Structure)	材料 (Material)
19	卫生间隐私门 Bathroom privacy door	磨砂钢化玻璃 Frosted tempered glass
20	挂衣架毛巾架 Hanger Towel Rack	挂衣架毛巾架 Hanger Towel Rack
21	花洒 Shower	50L桶式热水器 50L bucket water heater
22	台盆 Basin	台上盆 Above counter basin
23	马桶 Toilet	智能马桶 Smart toilet
24	水龙头 Faucet	高脚水龙头 Tall faucet

其他配件(Other Accessories)	
No.	结构 (Structure)
25	运输固定件/连接件 Shipping Fixtures/Connectors
26	插卡通电/取卡通电 Plug in card power/take card power

选配配件(Optional accessories)			
No.	结构 (Structure)	No.	结构 (Structure)
27	地暖:电地暖 Floor heating: Electric floor heating	33	多情景模式功能面板 Multi-scene mode function panel
28	管道防冻:电伴热 Pipeline antifreeze: electric heat tracing	34	照明智能控制 Intelligent lighting control
29	影音设备:投影仪 Audio-visual equipment: Projector	35	窗帘智能控制 Intelligent curtain control
30	天窗 Skylight	36	智能语音系统 Intelligent voice system
31	循环换气系统 Circulation ventilation system	37	酒店链接系统 Hotel link system
32	安全报警:烟感 Security alarm: smoke		







PRODUCT INTRODUCTION

产品介绍



SPACE CABIN ACCOMMODATION MODULE

星宿

星宿 | SPACE CABIN
ACCOMMODATION MODULE

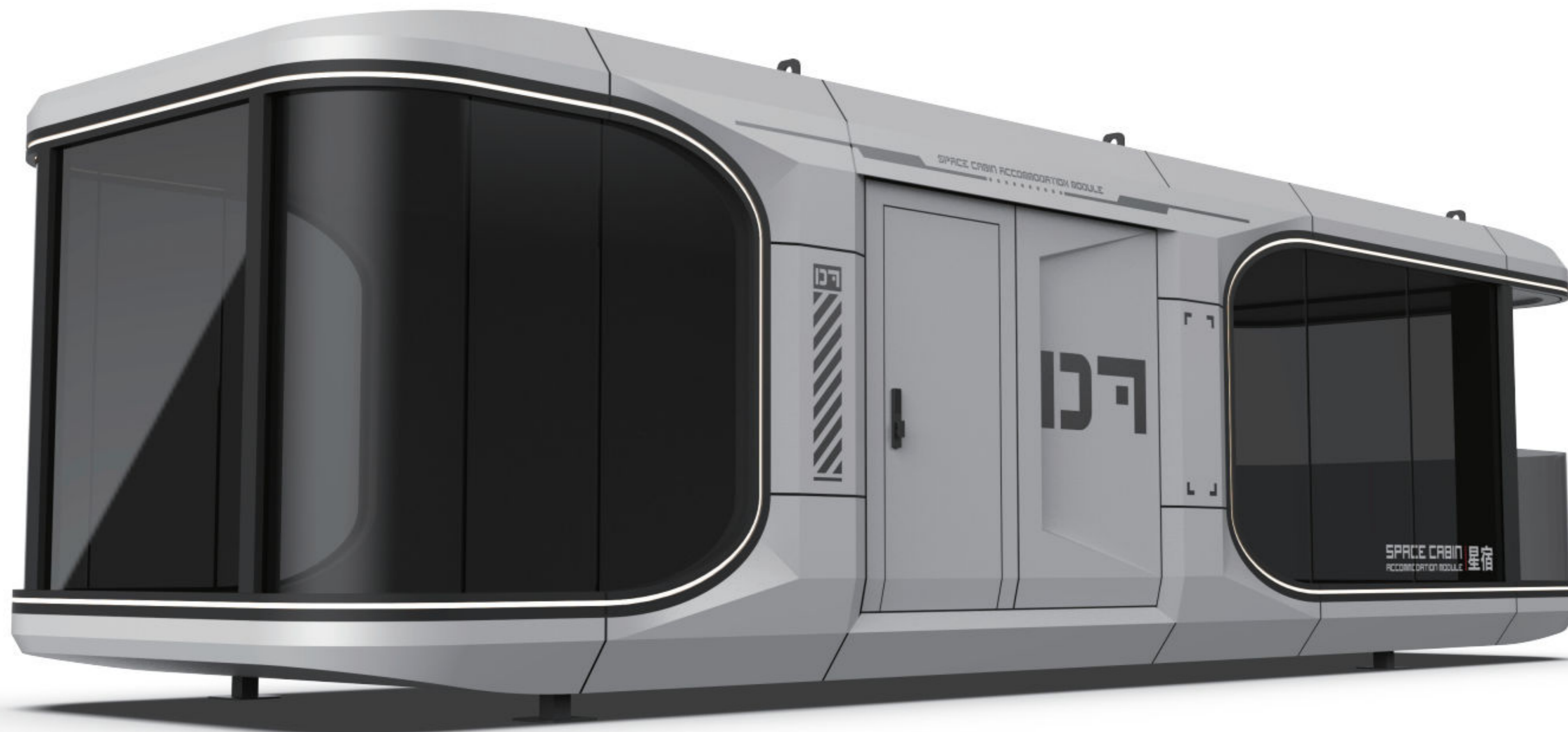

星宿

SPACE CABIN
ACCOMMODATION
MODULE

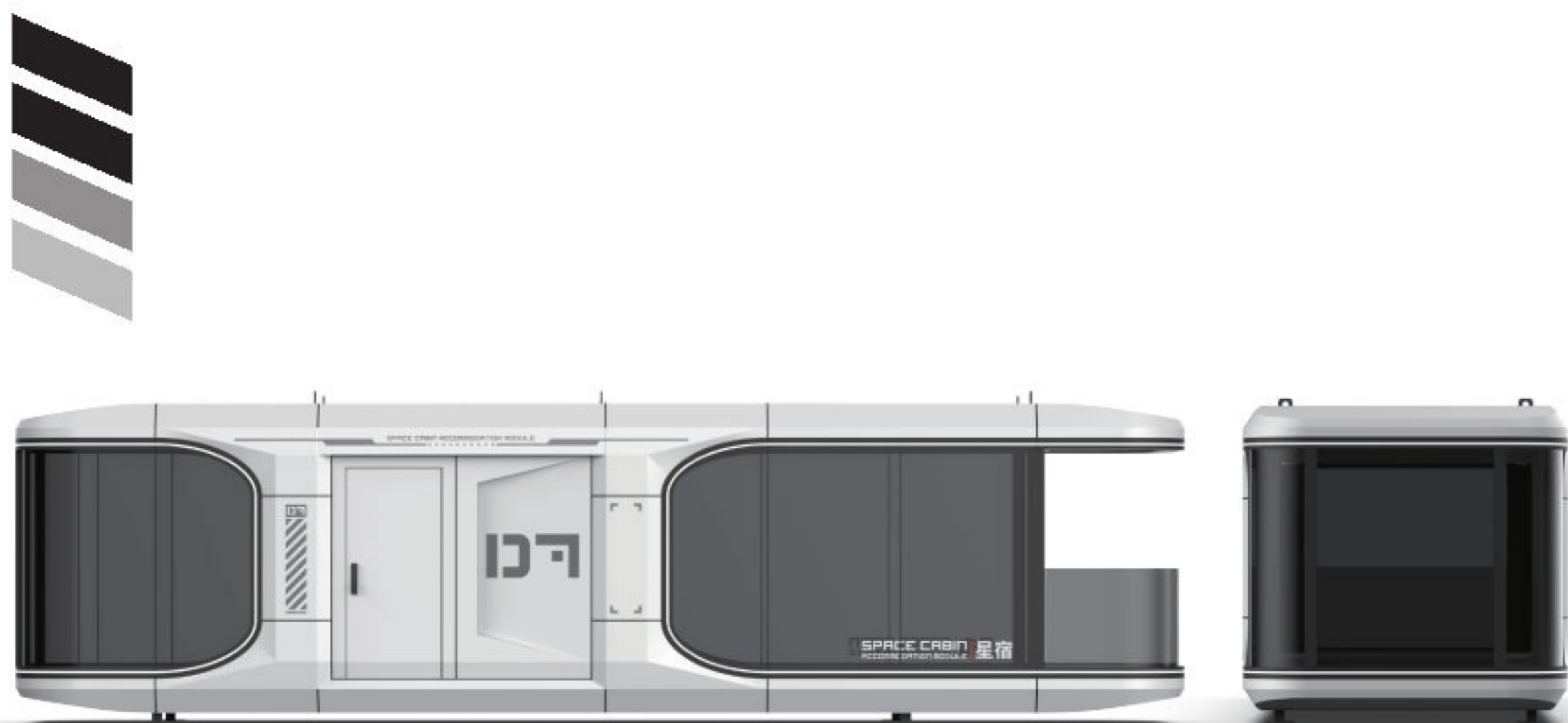



PRODUCT INTERIOR

产品内饰



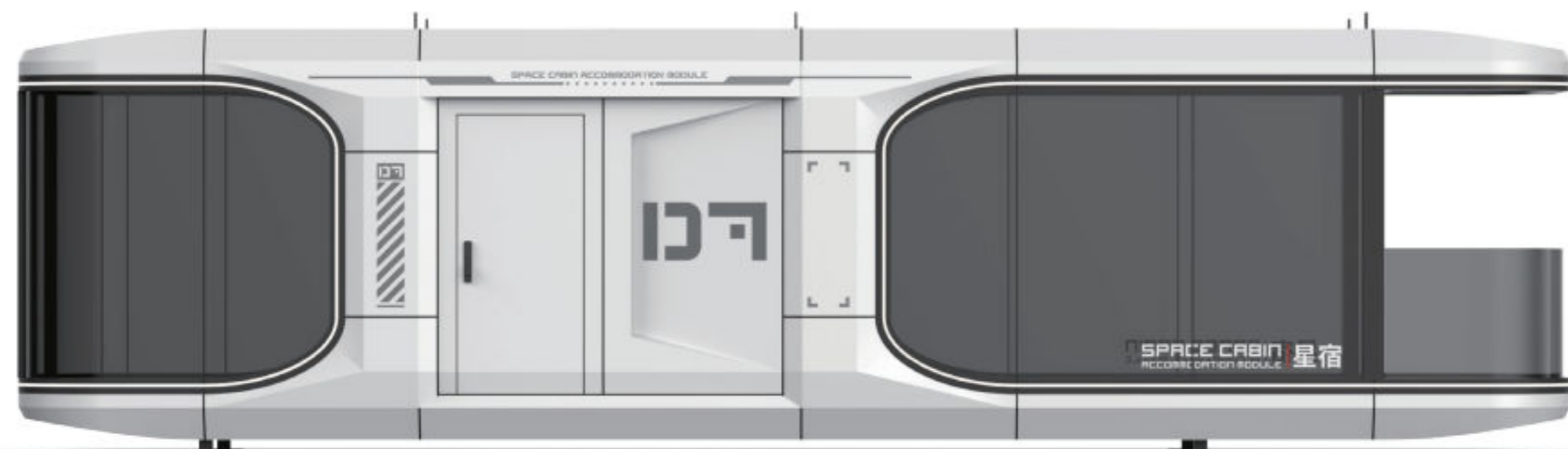

*以实物为准

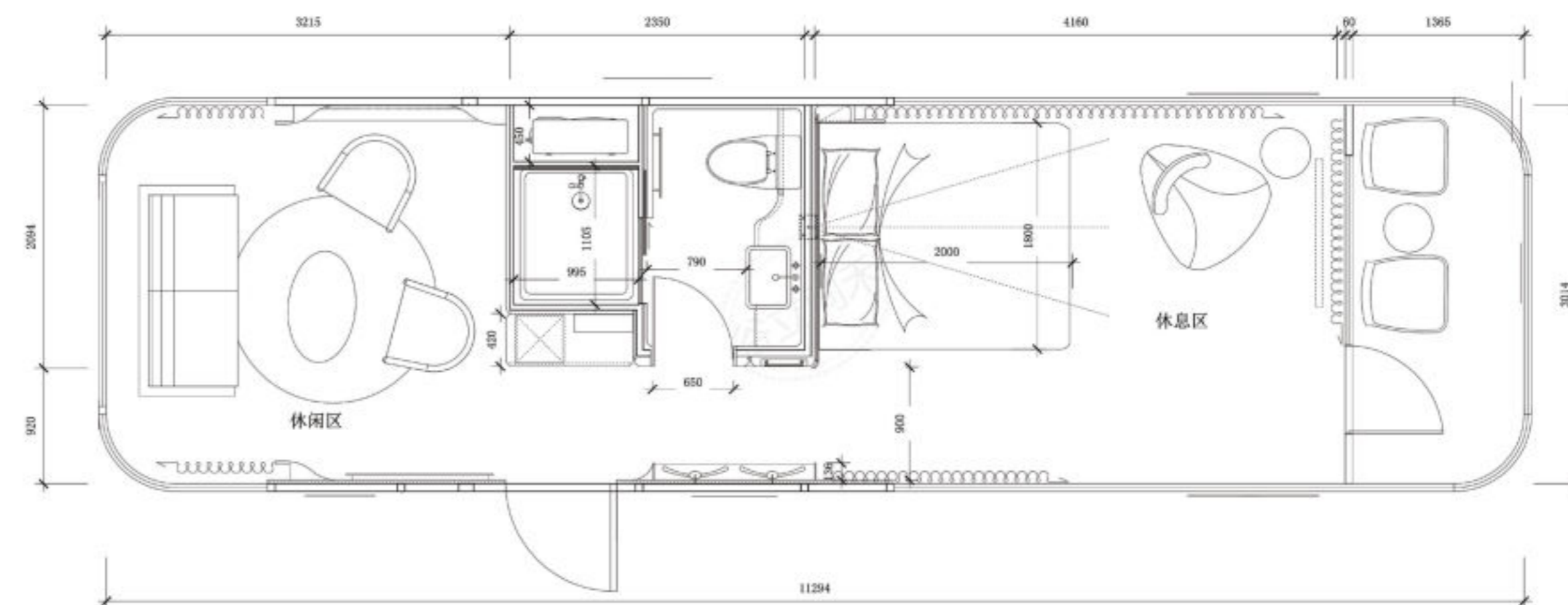

产品信息 (Configuration instructions)	
外形尺寸 Dimensions	11500mm*3300mm*3300mm
占地面积 Floor Area	38m ²
入住人数 Occupancy	2人
用电功率 Power consumption	12KW
约总重量 Approximate total weight	7吨

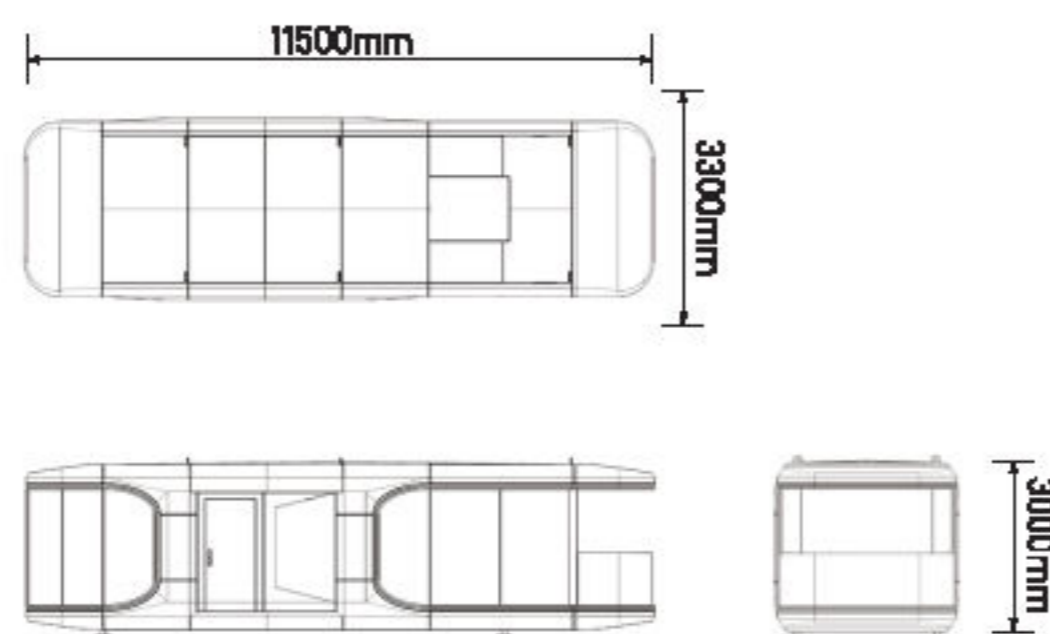

主体外结构 (Extracorporeal structure)		
No.	结构 (Structure)	材料 (Material)
1	钢结构框架 Steel structure frame	钢结构框架 Steel structure frame
2	外墙面板 Exterior wall panels	铝制 Aluminum
3	隔热保温 Heat insulation	100mm聚氨酯保温层 100mm polyurethane insulation layer
4	外墙玻璃 External wall glass	6+18A+6中空LOW-E玻璃或6+6夹胶隔热玻璃 6+18A+6 hollow LOW-E glass or 6+6 amine insulating glass
5	外壳表面处理 Shell surface treatment	金属氟碳漆烤漆 Metal fluorocarbon paint baking paint
6	阳台 Balcony	全景阳台(10mm钢化玻璃) Panoramic balcony (10mm tempered glass)
7	外围灯带 Peripheral light strip	外围灯带(环绕氛围灯带) Peripheral light strip (surrounding ambient light strip)
8	入户门 Entrance door	智能门禁系统 Intelligent access control system

舱内环保精装修 (Eco-friendly fine decoration inside Structural materials)		
No.	结构 (Structure)	材料 (Material)
9	天花板 Ceiling	可饰面一体板 Can be decorated with integrated board
10	墙面 Wall surface	可饰面一体板 Can be decorated with integrated board
11	地面 Floor	高级木纹锁扣地板 High-grade wood grain lock floor
12	室内灯效 Indoor lighting effect	3000K暖黄光 3000K warm yellow light
13	室外灯效 Outdoor lighting effect	4000K暖白光 4000K warm white light
14	窗帘 Curtain	电动窗帘 Electric curtain
15	指控系统 Control system	全屋集成智控系统 The whole house integrated intelligent control system
16	插座面板 Socket panel	品牌开关面板 Brand switch panel

全屋设备 (Whole house equipment)		
No.	结构 (Structure)	材料 (Material)
17	空调 Air conditioner	格力风管式空调 Gree ducted air conditioner
18	浴霸 Yuba	风暖式三合一集成浴霸 Air-heated three-in-one integrated bathroom

卫浴五金(Bathroom Fittings)		
No.	结构 (Structure)	材料 (Material)
19	卫生间隐私门 Bathroom privacy door	磨砂钢化玻璃 Frosted tempered glass
20	挂衣架毛巾架 Hanger Towel Rack	挂衣架毛巾架 Hanger Towel Rack
21	花洒 Shower	50L桶式热水器 50L bucket water heater
22	台盆 Basin	台上盆 Above counter basin
23	马桶 Toilet	智能马桶 Smart toilet
24	水龙头 Faucet	高脚水龙头 Tall faucet

其他配件(Other Accessories)	
No.	结构 (Structure)
25	运输固定件/连接件 Shipping Fixtures/Connectors
26	插卡通电/取卡通电 Plug in card power/take card power

选配配件(Optional accessories)			
No.	结构 (Structure)	No.	结构 (Structure)
27	地暖:电地暖 Floor heating: Electric floor heating	33	多情景模式功能面板 Multi-scene mode function panel
28	管道防冻:电伴热 Pipeline antifreeze: electric heat tracing	34	照明智能控制 Intelligent lighting control
29	影音设备:投影仪 Audio-visual equipment: Projector	35	窗帘智能控制 Intelligent curtain control
30	天窗 Skylight	36	智能语音系统 Intelligent voice system
31	循环换气系统 Circulation ventilation system	37	酒店链接系统 Hotel link system
32	安全报警:烟感 Security alarm: smoke		







129

星宿

129

X-Inspace

Science fiction-like life

Technology inspiration Beyond time and space

Technology / Intelligent caravan

CAUTION



SPACE CABIN
TOURIST ACCOMMODATION

星宿

MOBILE CAPSULE RESIDENCE

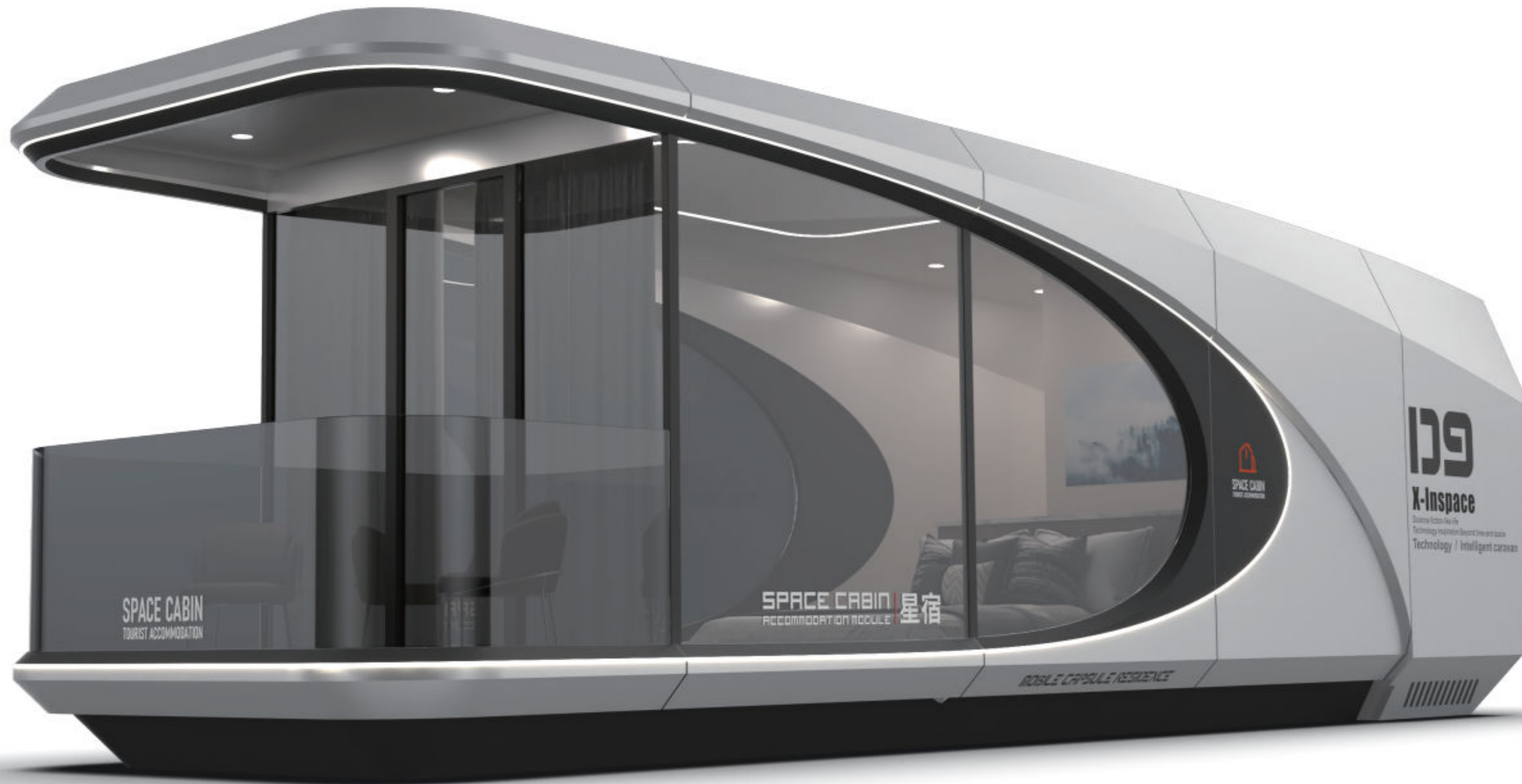

星宿

SPACE CABIN
ACCOMMODATION
MODULE





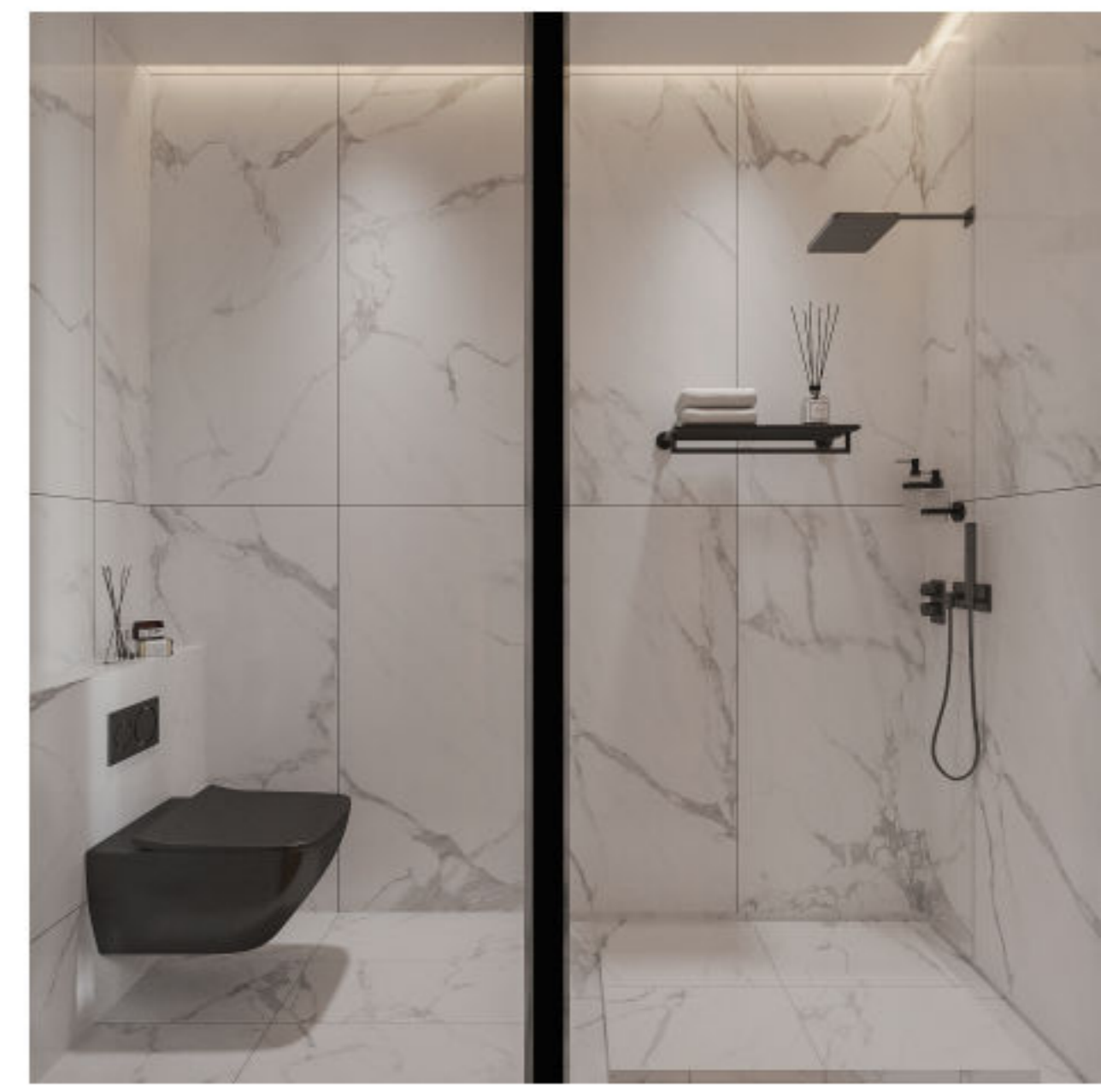

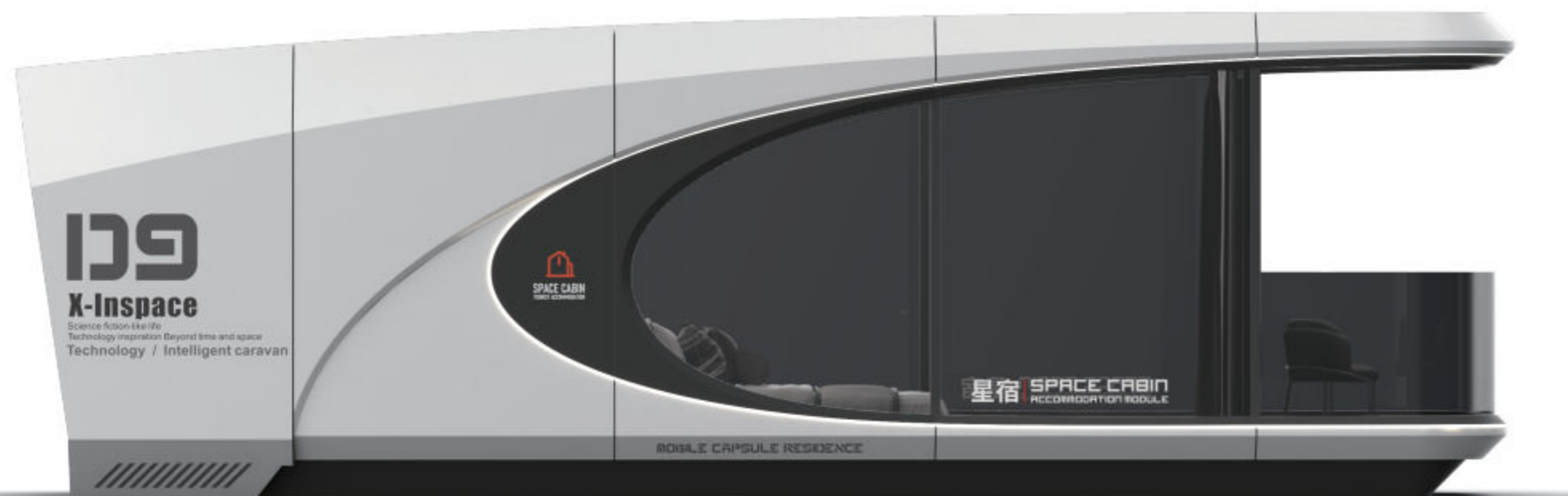

*以实物为准

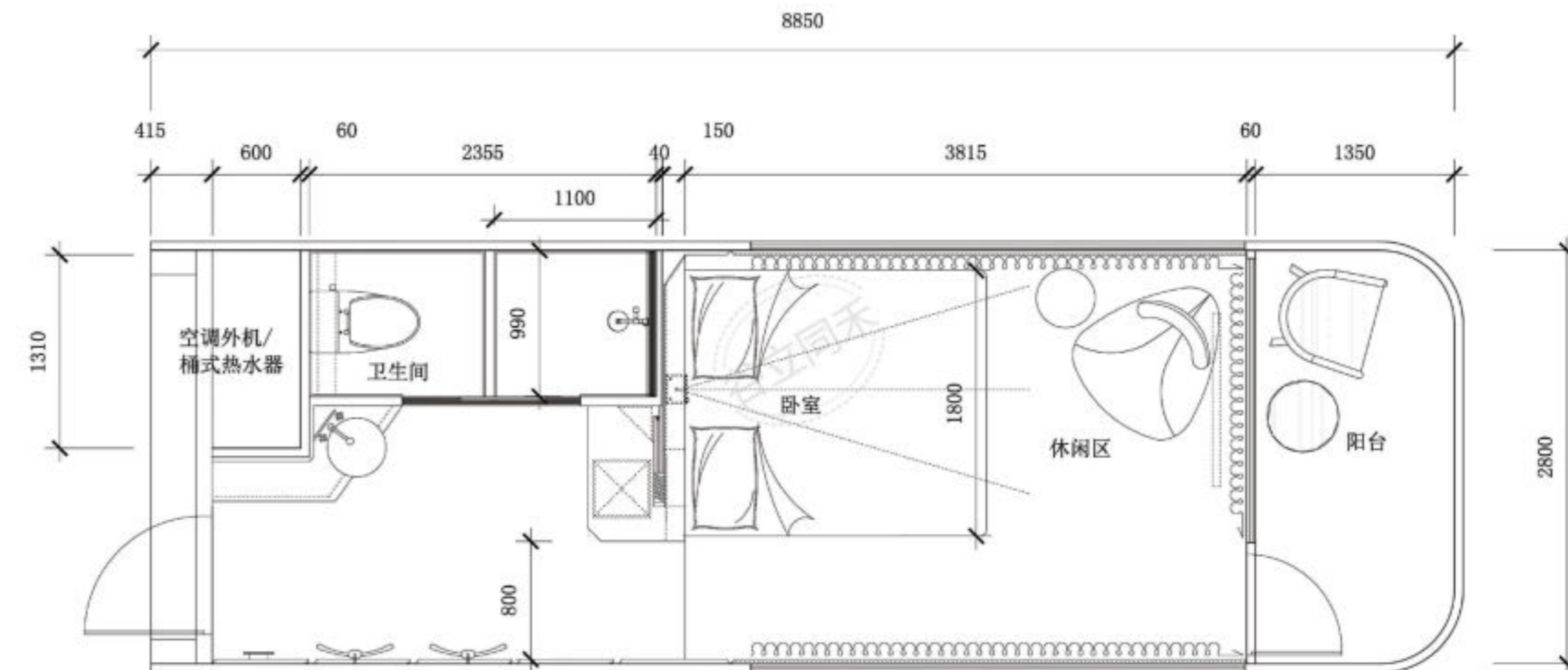

产品信息 (Configuration instructions)	
外形尺寸 Dimensions	9400mm*3000mm*3300mm
占地面积 Floor Area	29.7m ²
入住人数 Occupancy	2人
用电功率 Power consumption	12KW
约总重量 Approximate total weight	8吨

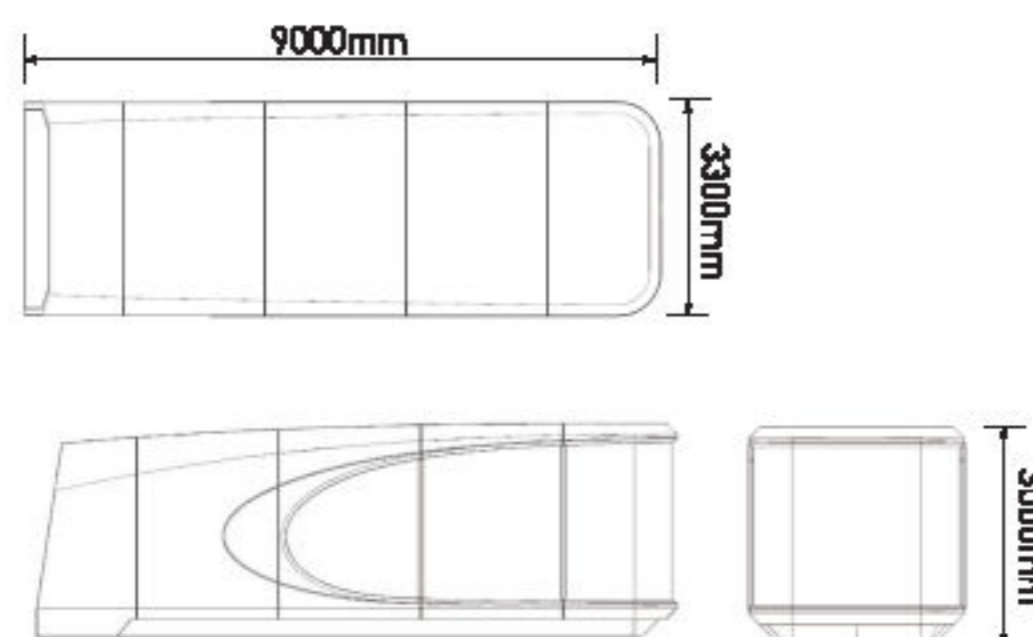

主体外结构 (Extracorporeal structure)		
No.	结构 (Structure)	材料 (Material)
1	钢结构框架 Steel structure frame	钢结构框架 Steel structure frame
2	外墙面板 Exterior wall panels	铝制 Aluminum
3	隔热保温 Heat insulation	100mm聚氨酯保温层 100mm polyurethane insulation layer
4	外墙玻璃 External wall glass	6+18A+6中空LOW-E玻璃或6+6夹胶隔热玻璃 6+18A+6 hollow LOW-E glass or 6+6 amine insulating glass
5	外壳表面处理 Shell surface treatment	金属氟碳漆烤漆 Metal fluorocarbon paint baking paint
6	阳台 Balcony	全景阳台(10mm钢化玻璃) Panoramic balcony (10mm tempered glass)
7	外围灯带 Peripheral light strip	外围灯带(环绕氛围灯带) Peripheral light strip (surrounding ambient light strip)
8	入户门 Entrance door	智能门禁系统 Intelligent access control system

舱内环保精装修 (Eco-friendly fine decoration inside Structural materials)		
No.	结构 (Structure)	材料 (Material)
9	天花板 Ceiling	可饰面一体板 Can be decorated with integrated board
10	墙面 Wall surface	可饰面一体板 Can be decorated with integrated board
11	地面 Floor	高级木纹锁扣地板 High-grade wood grain lock floor
12	室内灯效 Indoor lighting effect	3000K暖黄光 3000K warm yellow light
13	室外灯效 Outdoor lighting effect	4000K暖白光 4000K warm white light
14	窗帘 Curtain	电动窗帘 Electric curtain
15	指控系统 Control system	全屋集成智控系统 The whole house integrated intelligent control system
16	插座面板 Socket panel	品牌开关面板 Brand switch panel

全屋设备 (Whole house equipment)		
No.	结构 (Structure)	材料 (Material)
17	空调 Air conditioner	格力风管式空调 Gree ducted air conditioner
18	浴霸 Yuba	风暖式三合一集成浴霸 Air-heated three-in-one integrated bathroom



其他配件(Other Accessories)	
No.	结构 (Structure)
25	运输固定件/连接件 Shipping Fixtures/Connectors
26	插卡通电/取卡通电 Plug in card power/take card power

选配配件(Optional accessories)			
No.	结构 (Structure)	No.	结构 (Structure)
27	地暖: 电地暖 Floor heating: Electric floor heating	33	多情景模式功能面板 Multi-scene mode function panel
28	管道防冻: 电伴热 Pipeline antifreeze: electric heat tracing	34	照明智能控制 Intelligent lighting control
29	影音设备: 投影仪 Audio-visual equipment: Projector	35	窗帘智能控制 Intelligent curtain control
30	天窗 Skylight	36	智能语音系统 Intelligent voice system
31	循环换气系统 Circulation ventilation system	37	酒店链接系统 Hotel link system
32	安全报警: 烟感 Security alarm: smoke		

卫浴五金(Bathroom Fittings)		
No.	结构 (Structure)	材料 (Material)
19	卫生间隐私门 Bathroom privacy door	磨砂钢化玻璃 Frosted tempered glass
20	挂衣架毛巾架 Hanger Towel Rack	挂衣架毛巾架 Hanger Towel Rack
21	花洒 Shower	50L桶式热水器 50L bucket water heater
22	台盆 Basin	台上盆 Above counter basin
23	马桶 Toilet	智能马桶 Smart toilet
24	水龙头 Faucet	高脚水龙头 Tall faucet





SPACE CABIN 星宿
ACCOMMODATION MODULE

01

X-Inspace

Science fiction-like life
Technology Inspiration Beyond time and space
Technology / Intelligent caravan

PRODUCT INTRODUCTION

产品介绍



D2



星宿 | SPACE CABIN
ACCOMMODATION MODULE

SPACE C
TOURIST ACCOM



星宿

SPACE CABIN
ACCOMMODATION
MODULE

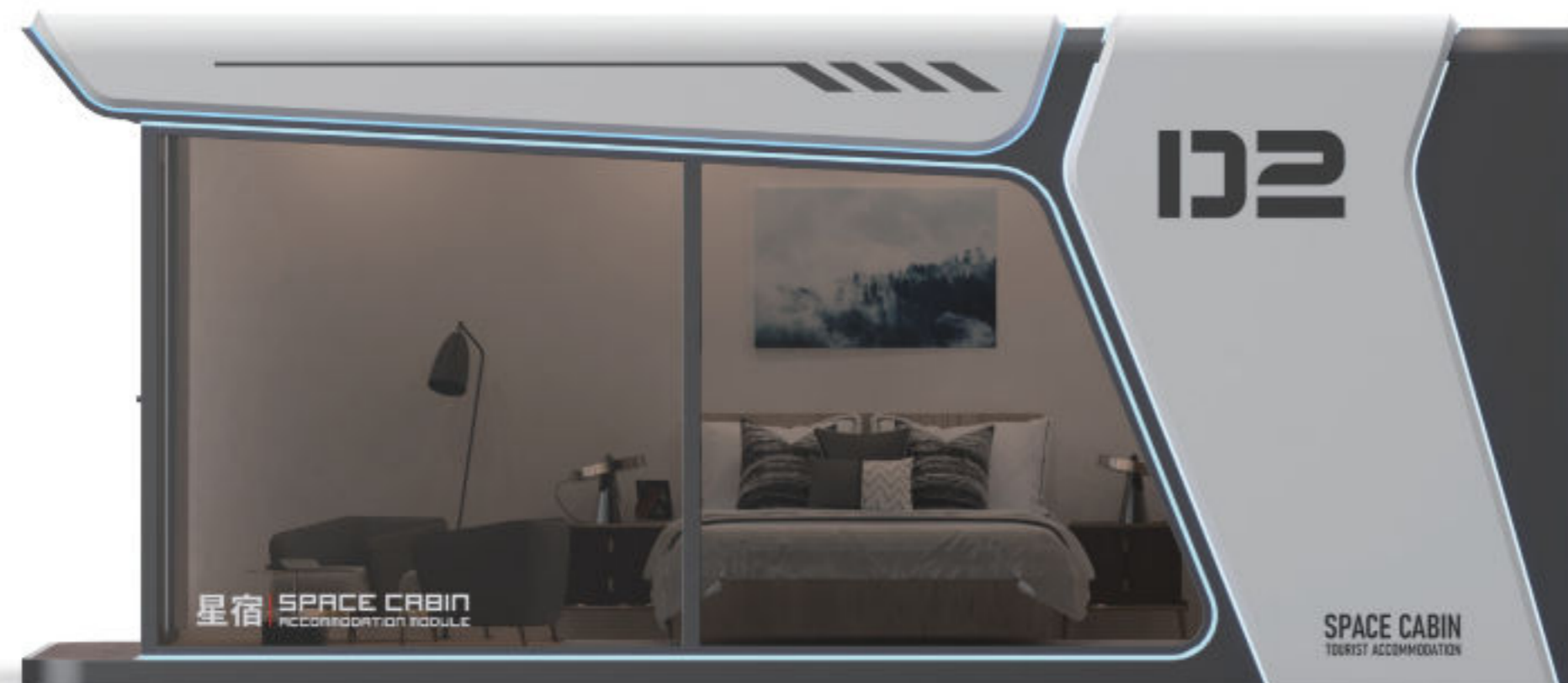

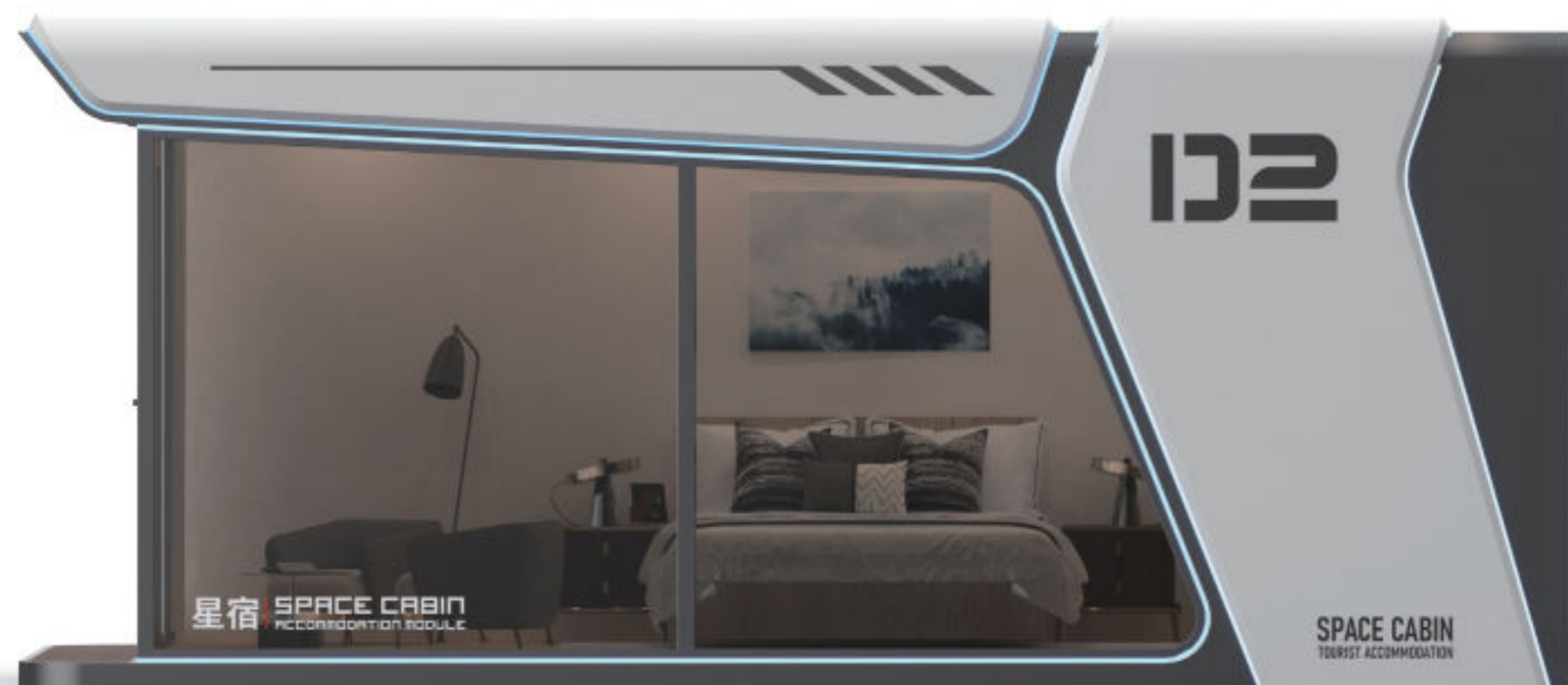

*以实物为准

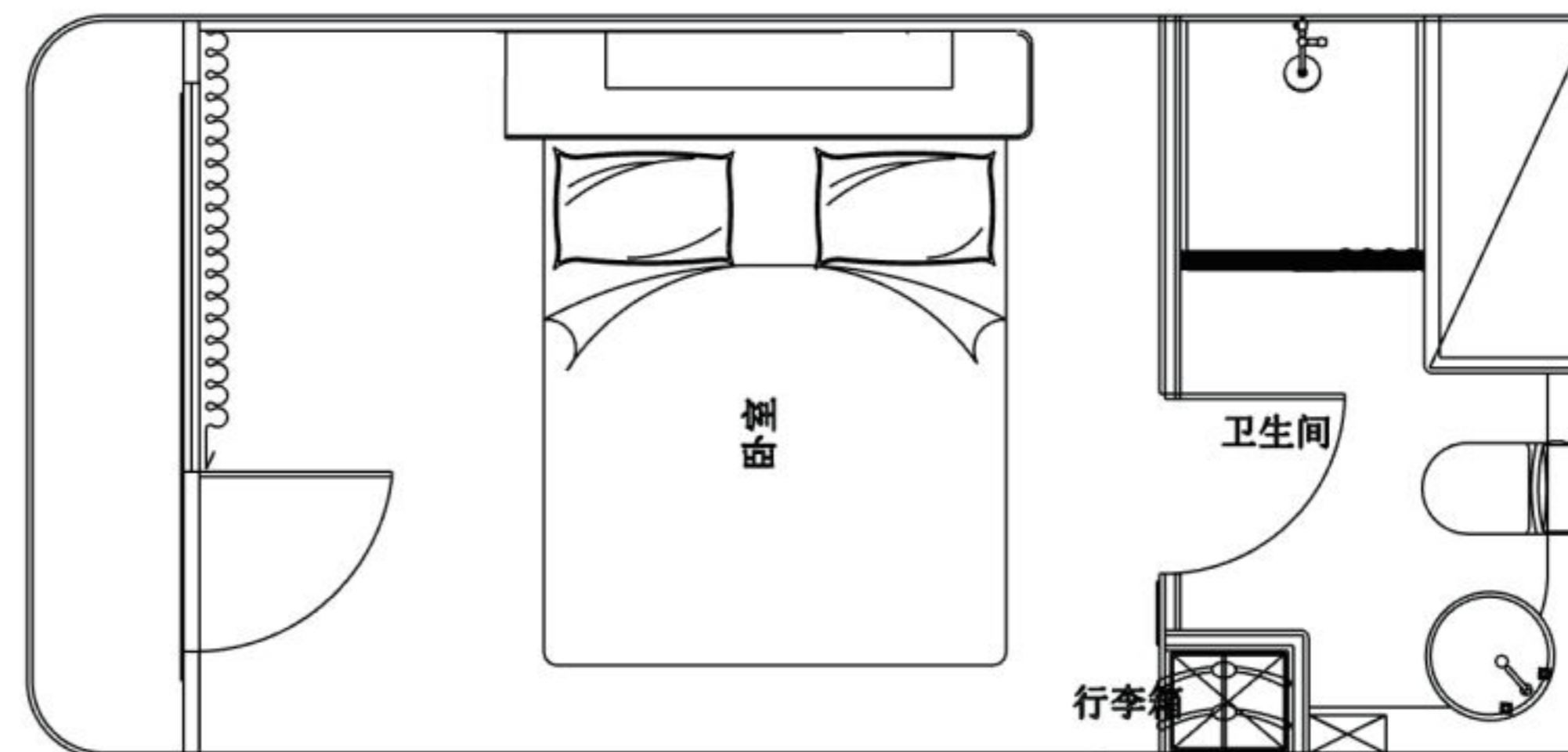

产品信息 (Configuration instructions)

外形尺寸 Dimensions	7000mm*3000mm*3200mm
占地面积 Floor Area	22.4m ²
入住人数 Occupancy	2人
用电功率 Power consumption	12KW
约总重量 Approximate total weight	6吨

主体外结构 (Extracorporeal structure)

No.	结构 (Structure)	材料 (Material)
1	钢结构框架 Steel structure frame	钢结构框架 Steel structure frame
2	外墙面板 Exterior wall panels	铝制 Aluminum
3	隔热保温 Heat insulation	100mm聚氨酯保温层 100mm polyurethane insulation layer
4	外墙玻璃 External wall glass	6+18A+6中空LOW-E玻璃或6+6夹胶隔热玻璃 6+18A+6 hollow LOW-E glass or 6+6 amine insulating glass
5	外壳表面处理 Shell surface treatment	金属氟碳漆烤漆 Metal fluorocarbon paint baking paint
6	阳台 Balcony	全景阳台(10mm钢化玻璃) Panoramic balcony (10mm tempered glass)
7	外围灯带 Peripheral light strip	外围灯带(环绕氛围灯带) Peripheral light strip (surrounding ambient light strip)
8	入户门 Entrance door	智能门禁系统 Intelligent access control system

舱内环保精装修 (Eco-friendly fine decoration inside Structural materials)

No.	结构 (Structure)	材料 (Material)
9	天花板 Ceiling	可饰面一体板 Can be decorated with integrated board
10	墙面 Wall surface	可饰面一体板 Can be decorated with integrated board
11	地面 Floor	高级木纹锁扣地板 High-grade wood grain lock floor
12	室内灯效 Indoor lighting effect	3000K暖黄光 3000K warm yellow light
13	室外灯效 Outdoor lighting effect	4000K暖白光 4000K warm white light
14	窗帘 Curtain	电动窗帘 Electric curtain
15	指控系统 Control system	全屋集成智控系统 The whole house integrated intelligent control system
16	插座面板 Socket panel	品牌开关面板 Brand switch panel

全屋设备 (Whole house equipment)

No.	结构 (Structure)	材料 (Material)
17	空调 Air conditioner	格力风管式空调 Gree ducted air conditioner
18	浴霸 Yuba	风暖式三合一集成浴霸 Air-heated three-in-one integrated bathroom



卫浴五金(Bathroom Fittings)

No.	结构 (Structure)	材料 (Material)
19	卫生间隐私门 Bathroom privacy door	磨砂钢化玻璃 Frosted tempered glass
20	挂衣架毛巾架 Hanger Towel Rack	挂衣架毛巾架 Hanger Towel Rack
21	花洒 Shower	50L桶式热水器 50L bucket water heater
22	台盆 Basin	台上盆 Above counter basin
23	马桶 Toilet	智能马桶 Smart toilet
24	水龙头 Faucet	高脚水龙头 Tall faucet

选配配件(Optional accessories)

No.	结构 (Structure)	No.	结构 (Structure)
27	地暖:电地暖 Floor heating: Electric floor heating	33	多情景模式功能面板 Multi-scene mode function panel
28	管道防冻:电伴热 Pipeline antifreeze: electric heat tracing	34	照明智能控制 Intelligent lighting control
29	影音设备:投影仪 Audio-visual equipment: Projector	35	窗帘智能控制 Intelligent curtain control
30	天窗 Skylight	36	智能语音系统 Intelligent voice system
31	循环换气系统 Circulation ventilation system	37	酒店链接系统 Hotel link system
32	安全报警:烟感 Security alarm: smoke		

其他配件(Other Accessories)

No.	结构 (Structure)
25	运输固定件/连接件 Shipping Fixtures/Connectors
26	插卡通电/取卡通电 Plug in card power/take card power

128

星宿 TRAVELER
ACCOMMODATION MODULE

128

128

星宿

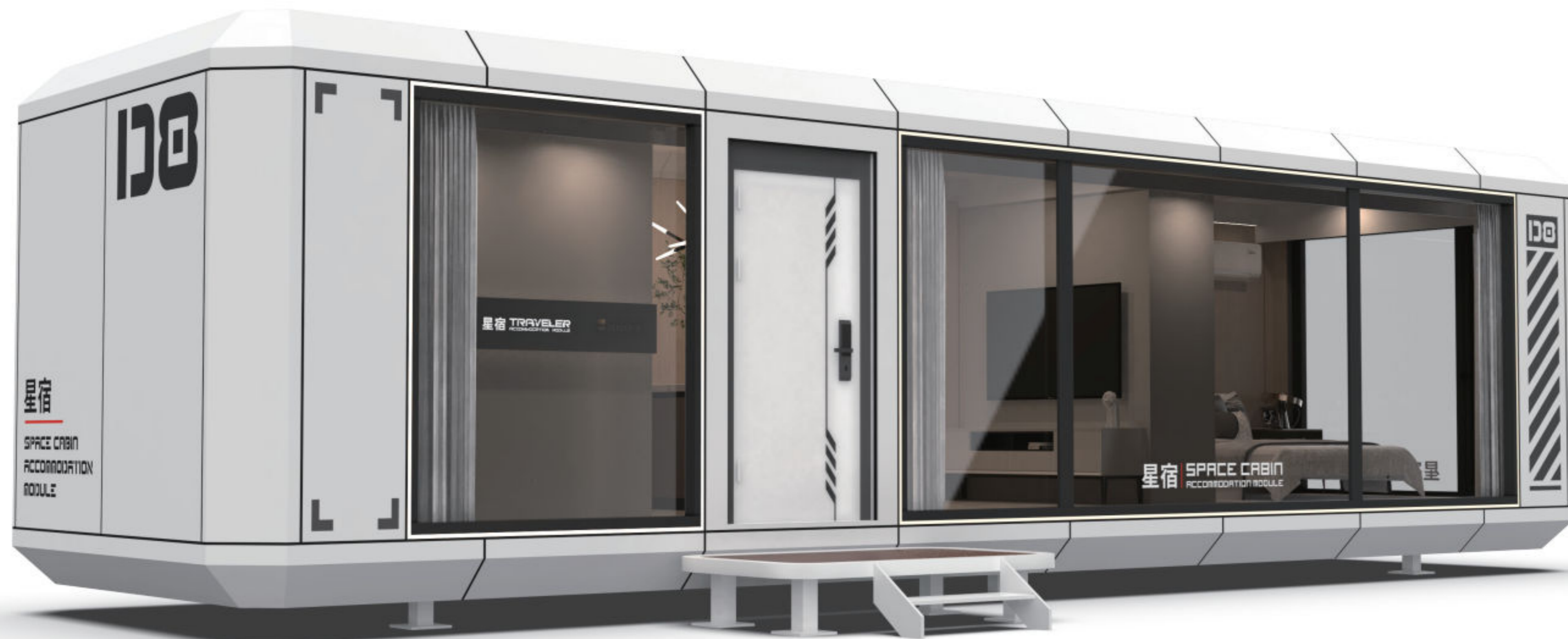

星宿

SPACE CABIN
ACCOMMODATION
MODULE

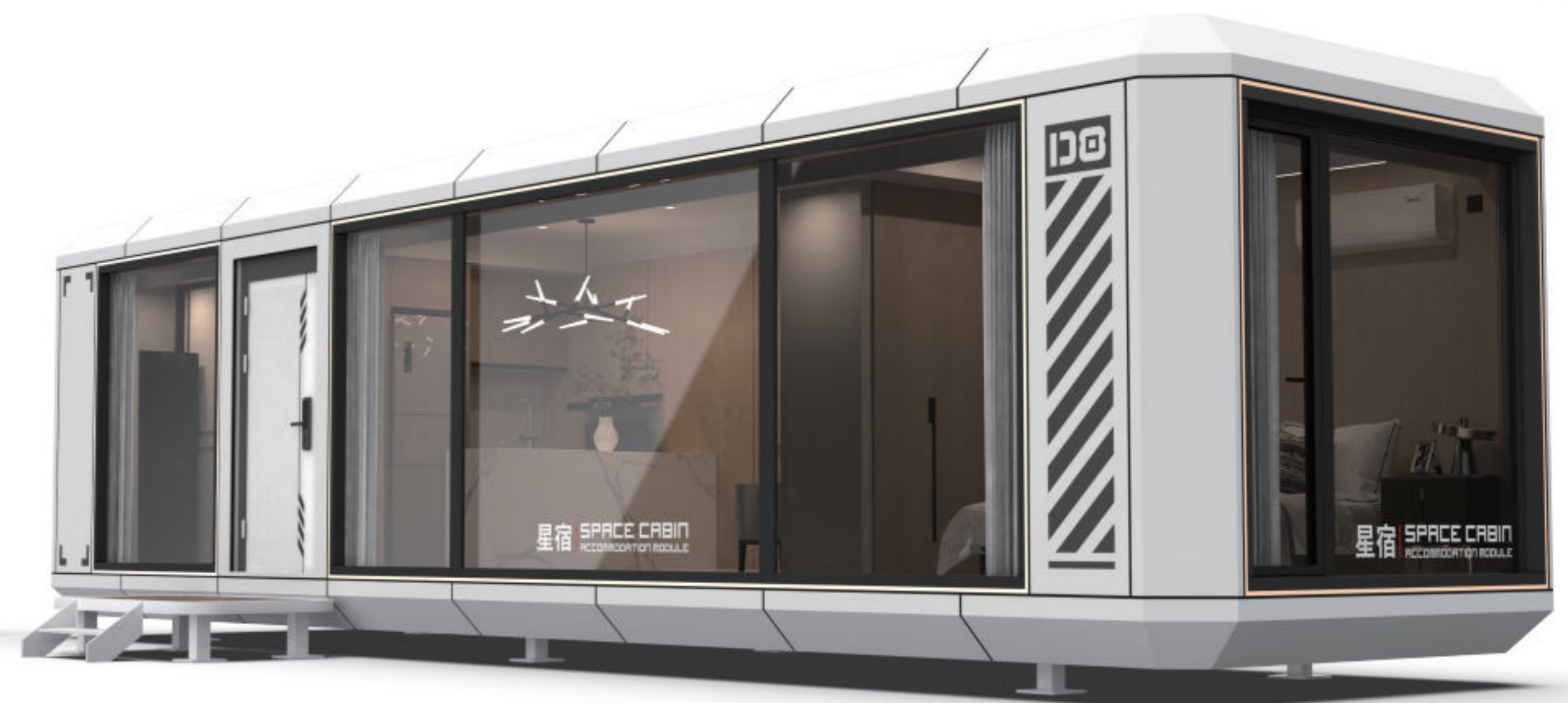

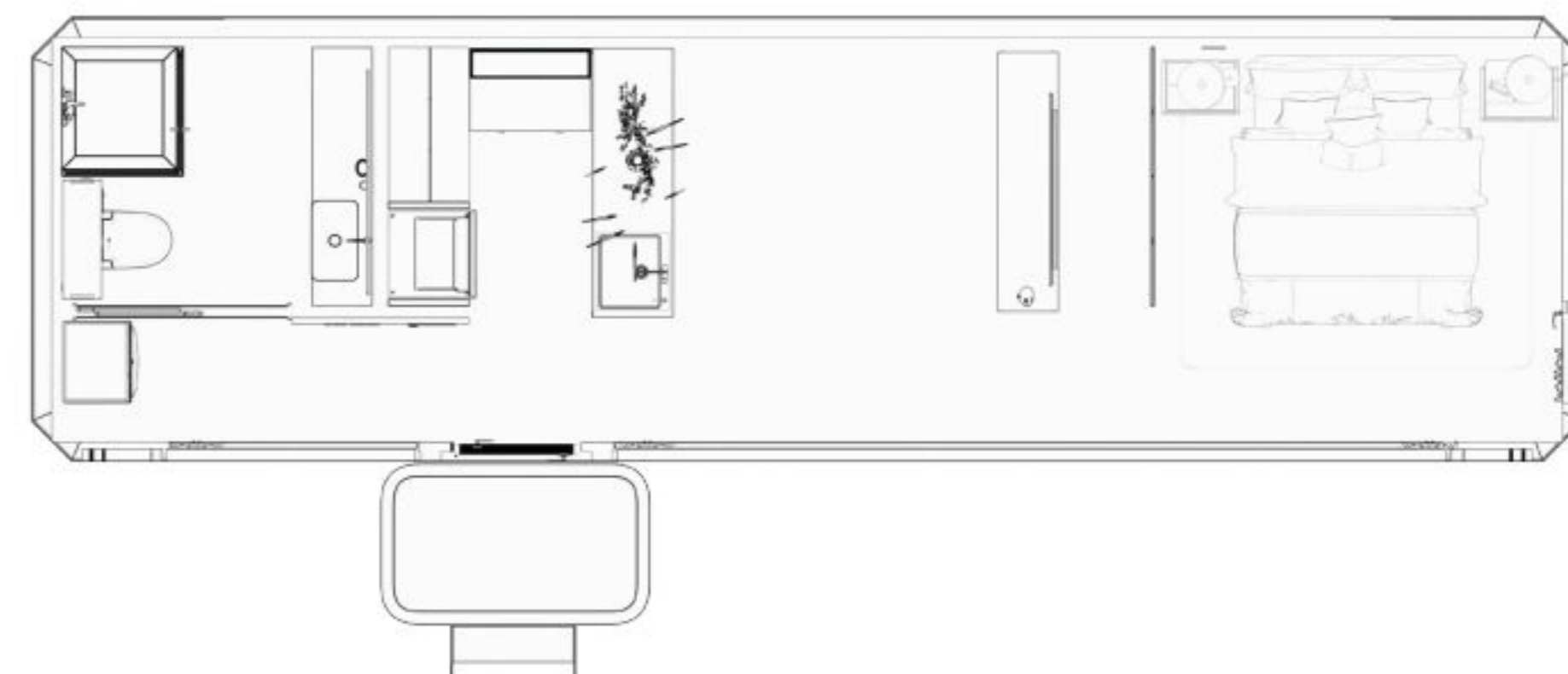

*以实物为准

产品信息 (Configuration instructions)

外形尺寸 Dimensions	9400mm*3000mm*3300mm
占地面积 Floor Area	29.7m ²
入住人数 Occupancy	2人
用电功率 Power consumption	12KW
约总重量 Approximate total weight	8吨

主体外结构 (Extracorporeal structure)

No.	结构 (Structure)	材料 (Material)
1	钢结构框架 Steel structure frame	钢结构框架 Steel structure frame
2	外墙面板 Exterior wall panels	铝制 Aluminum
3	隔热保温 Heat insulation	100mm聚氨酯保温层 100mm polyurethane insulation layer
4	外墙玻璃 External wall glass	6+18A+6中空LOW-E玻璃或6+6夹胶隔热玻璃 6+18A+6 hollow LOW-E glass or 6+6 amine insulating glass
5	外壳表面处理 Shell surface treatment	金属氟碳漆烤漆 Metal fluorocarbon paint baking paint
6	阳台 Balcony	全景阳台(10mm钢化玻璃) Panoramic balcony (10mm tempered glass)
7	外围灯带 Peripheral light strip	外围灯带(环绕氛围灯带) Peripheral light strip (surrounding ambient light strip)
8	入户门 Entrance door	智能门禁系统 Intelligent access control system

舱内环保精装修 (Eco-friendly fine decoration inside Structural materials)

No.	结构 (Structure)	材料 (Material)
9	天花板 Ceiling	可饰面一体板 Can be decorated with integrated board
10	墙面 Wall surface	可饰面一体板 Can be decorated with integrated board
11	地面 Floor	高级木纹锁扣地板 High-grade wood grain lock floor
12	室内灯效 Indoor lighting effect	3000K暖黄光 3000K warm yellow light
13	室外灯效 Outdoor lighting effect	4000K暖白光 4000K warm white light
14	窗帘 Curtain	电动窗帘 Electric curtain
15	指控系统 Control system	全屋集成智控系统 The whole house integrated intelligent control system
16	插座面板 Socket panel	品牌开关面板 Brand switch panel

全屋设备 (Whole house equipment)

No.	结构 (Structure)	材料 (Material)
17	空调 Air conditioner	格力风管式空调 Gree ducted air conditioner
18	浴霸 Yuba	风暖式三合一集成浴霸 Air-heated three-in-one integrated bathroom

卫浴五金(Bathroom Fittings)		
No.	结构 (Structure)	材料 (Material)
19	卫生间隐私门 Bathroom privacy door	磨砂钢化玻璃 Frosted tempered glass
20	挂衣架毛巾架 Hanger Towel Rack	挂衣架毛巾架 Hanger Towel Rack
21	花洒 Shower	50L桶式热水器 50L bucket water heater
22	台盆 Basin	台上盆 Above counter basin
23	马桶 Toilet	智能马桶 Smart toilet
24	水龙头 Faucet	高脚水龙头 Tall faucet

其他配件(Other Accessories)	
No.	结构 (Structure)
25	运输固定件/连接件 Shipping Fixtures/Connectors
26	插卡通电/取卡通电 Plug in card power/take card power

选配配件(Optional accessories)			
No.	结构 (Structure)	No.	结构 (Structure)
27	地暖:电地暖 Floor heating: Electric floor heating	33	多情景模式功能面板 Multi-scene mode function panel
28	管道防冻:电伴热 Pipeline antifreeze: electric heat tracing	34	照明智能控制 Intelligent lighting control
29	影音设备:投影仪 Audio-visual equipment: Projector	35	窗帘智能控制 Intelligent curtain control
30	天窗 Skylight	36	智能语音系统 Intelligent voice system
31	循环换气系统 Circulation ventilation system	37	酒店链接系统 Hotel link system
32	安全报警:烟感 Security alarm: smoke		



Jinhua ZhongXing Communication Technology Co., LTD.

E-Mail: GlobalSales@jhzxct.com

Official site: www.jhzxct.com

Headquarter: Shicheng street #448, Wucheng district, Jinhua
Zhejiang, China

Technical and Sales Center: Sunyard international 1-3408, 1750
Jinaghong Rd, Binjiang district, Hangzhou Zhejiang, China

Shanghai Office: Room 4-501, Zhengjiangxi Rd #386, Jing'an
District, Shanghai , China